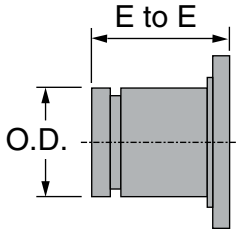

FIG. F-2 Flange Nipple



F-2 FLANGE NIPPLE			
Nominal Size	O.D.	End to End	Approx. Wt. Ea.
In./DN(mm)	In./mm	In./mm	Lbs./Kg
1	1.315	4	2.7
25	33.4	102	1.2
1 1/4	1.660	4	3.3
32	42.2	102	1.5
1 1/2	1.900	4	3.9
40	48.3	102	1.8
2	2.375	4	6.2
50	60.3	102	2.8
2 1/2	2.875	4	9.9
65	73.0	102	4.5
3	3.500	4	11.4
80	88.9	102	5.0
4	4.500	6	47.0
100	114.3	152	21.3
5	5.563	6	40.0
125	141.3	152	18.1
6	6.625	6	50.0
150	168.3	152	22.7
8	8.625	6	60.0
200	219.1	152	27.2
10	10.750	8	60.0
250	273.1	203	27.2
12	12.750	8	91.0
300	323.9	203	41.3

Larger sizes available upon request, contact an Anvil Representative.

MATERIAL SPECIFICATIONS

FLANGE:

Class 150 Carbon Steel Raised Face Flange

FABRICATED FITTINGS:

1"-10" Carbon Steel, Schedule 40, conforming to ASTM A-53, Grade B

12" and above Carbon Steel, Standard Wall, conforming to ASTM A-53, Grade B

COATINGS:

- Rust inhibiting paint Color: ORANGE or BLACK (standard) or
- Hot Dipped Zinc Galvanized conforming to ASTM A-153 (optional)
- Other available options: Example: RAL3000 or RAL9000 Series

PROJECT INFORMATION		APPROVAL STAMP	
Project:		<input type="checkbox"/> Approved	
Address:		<input type="checkbox"/> Approved as noted	
Contractor:		<input type="checkbox"/> Not approved	
Engineer:		Remarks:	
Submittal Date:			
Notes 1:			
Notes 2:			