

# FIG. 7106 Sock-It® Reducing Run Outlet Tee



(Sock-It x Sock-It x NPT)

The Gruvlok Sock-It® Piping Method provides a quick, secure and reliable method of joining plain-end steel pipe. Several Sock-It® configurations are available: tees with NPT outlets, reducing run tees with NPT outlets, straight couplings, 90° elbows, straight tees and reducing elbows. Pressure energized elastomeric gaskets provide the Sock-It® with a leak-tight seal. Specially designed lock bolts secure the pipe in the Sock-It® Fitting, providing a fast, dependable way of joining small diameter plain-end pipe.

The Gruvlok Sock-It Fittings are designed to accommodate the rigorous requirements of UL/ULC Listed and FM Approved for use in both wet and dry fire protection systems. The threaded Sock-It Fittings connections permit installation of sprinklers (including dry pendent sprinklers) directly into the Sock-It Fitting. The Sock-It Piping Method provides a fast, dependable and economical method of connecting pipe for many other mechanical steel pipe systems.

Working pressure ratings shown are for reference only and are based on schedule 40 pipe. For the latest UL/ULC Listed and FM approved pressure ratings versus pipe schedule, see [www.anvilintl.com](http://www.anvilintl.com) or contact your local Anvil Sales Representative.

**NOTE:** All Sock-It fittings are UL/ULC Listed and FM Approved for 175 psi working pressure when used to join XL Pipe and Dyna-Flow Pipe.



For Listings/Approval Details and Limitations, visit our website at [www.anvilintl.com](http://www.anvilintl.com) or contact an Anvil® Sales Representative.

## MATERIAL SPECIFICATIONS

### HOUSING:

Cast Iron conforming to ASTM A126 CLASS A.

### BOLTS:

Case hardened carbon steel, dichromate finish.

### GASKETS:

Grade "E" EPDM, as specified in accordance with ASTM D2000.

### LUBRICATION:

Standard Gruvlok

PROJECT INFORMATION		APPROVAL STAMP
Project:		<input type="checkbox"/> Approved
Address:		<input type="checkbox"/> Approved as noted
Contractor:		<input type="checkbox"/> Not approved
Engineer:		Remarks:
Submittal Date:		
Notes 1:		
Notes 2:		

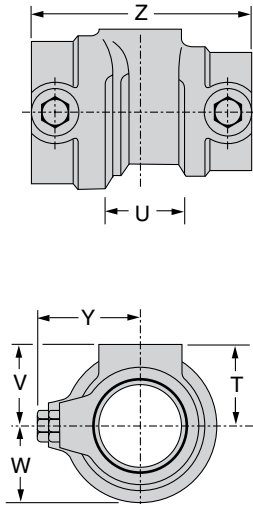

**FIGURE 7106 SOCK-IT® REDUCING RUN OUTLET TEE (SxSxNPT)**

Nominal Size	Max. Working Pressure		Dimensions						Approx. Wt. Ea.
	UL/ULC Listed	FM Approved	T**	U*	V	W	Y	Z	Lbs./Kg
In./DN(mm)	PSI/bar	PSI/bar	In./mm	In./mm	In./mm	In./mm	In./mm	In./mm	
1¼ x 1 x ½ 32 x 25 x 15	300 2.1	300 2.1	1 25	1⅜ 35	1⅞ 37	1¼ 32	1⅜ 46	4¼ 108	2.1 1.0
1¼ x 1 x ¾ 32 x 25 x 20	300 20.7	300 20.7	7⁄8 22	1⅜ 35	1⅞ 37	1¼ 32	1⅜ 46	4¼ 108	2.1 1.0
1¼ x 1 x 1 32 x 25 x 25	300 20.7	300 20.7	7⁄8 22	1⅜ 35	1⅞ 37	1¼ 32	1⅜ 46	4¼ 108	2.0 0.9
1½ x 1¼ x ½ 40 x 32 x 15	300 20.7	300 20.7	1⅞ 29	1⅜ 35	1⅞ 40	1⅜ 35	1⅝ 49	4⅜ 111	2.5 1.1
1½ x 1¼ x ¾ 40 x 32 x 20	300 20.7	300 20.7	1 25	1⅜ 35	1⅞ 40	1⅜ 35	1⅝ 49	4⅜ 111	2.4 1.1
1½ x 1¼ x 1 40 x 32 x 25	300 20.7	300 20.7	1 25	1⅜ 35	1⅞ 40	1⅜ 35	1⅝ 49	4⅜ 111	2.2 1.0
2 x 1½ x ½ 50 x 40 x 15	175 12.1	250 17.2	1¼ 32	1⅜ 35	1¾ 44	1⅝ 41	2⅜ 56	4⅞ 116	3.2 1.5
2 x 1½ x ¾ 50 x 40 x 20	175 12.1	250 17.2	1⅞ 29	1⅜ 35	1¾ 44	1⅝ 41	2⅜ 56	4⅞ 116	3.1 1.4
2 x 1½ x 1 50 x 40 x 25	175 12.1	250 17.2	1⅞ 29	1⅜ 35	1¾ 44	1⅝ 41	2⅜ 56	4⅞ 116	3.0 1.4

\* "U" - Run Take-out dimension.  
 \*\* "T" - Outlet Take-out dimension.

See Pipe-Preparation in the Technical Data Section for information on proper pipe preparation.