

## Weldless Eye Nut

**Fig. 290:** Right-Hand Thread

**Fig. 290L:** Left-Hand Thread

**Size Range:**  $\frac{3}{8}$ " through  $2\frac{1}{2}$ "

**Material:** Forged steel

**Finish:**  Plain or  Zinc Plated (Hot-Dip Galvanized optional)

**Service:** For use on high temperature piping installations.

**Approvals:** Complies with Federal Specification A-A-1192A (Type 17), WW-H-171-E (Type 17), ANSI/MSS SP-69 and MSS SP-58 (Type 17).

**Features:**

- Supports loads equal to the full limitation of the hanger rod.
- Provides flexible connection when used with straight thread rod.

**Ordering:** Specify rod size, figure number, name and finish. If other than standard combination of eye nut number and rod size, specify eye nut number and special rod tapping size.

**Note:** The acceptability of galvanized coatings at temperatures above 450°F is at the discretion of the end user. Larger eye nuts featuring smaller rod sizes are commonly available.

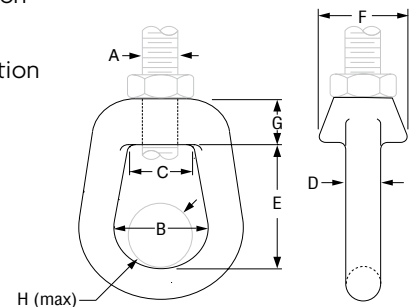

**FIG. 290, 290L: LOADS (LBS) • WEIGHTS (LBS) • DIMENSIONS (IN)**

| Rod Size<br>A  | Max Load |        | Weight | B               | C                | D               | E                | F                | G               | H              | Eye Nut Number |
|----------------|----------|--------|--------|-----------------|------------------|-----------------|------------------|------------------|-----------------|----------------|----------------|
|                | 650° F   | 750° F |        |                 |                  |                 |                  |                  |                 |                |                |
| $\frac{3}{8}$  | 730      | 572    | 0.28   | $1\frac{5}{32}$ | $\frac{13}{16}$  | $\frac{13}{32}$ | $1\frac{17}{32}$ | $\frac{31}{32}$  | $\frac{5}{8}$   | 1              | 0              |
| $\frac{1}{2}$  | 1,350    | 1,057  | 0.28   |                 |                  |                 |                  |                  |                 |                |                |
| $\frac{5}{8}$  | 2,160    | 1,692  | 0.62   | $1\frac{1}{2}$  | $\frac{13}{16}$  | $\frac{1}{2}$   | 2                | $1\frac{3}{8}$   | $\frac{11}{16}$ | $1\frac{1}{4}$ | 1              |
| $\frac{3}{4}$  | 3,230    | 2,530  | 0.60   |                 |                  |                 |                  |                  |                 |                |                |
| $\frac{7}{8}$  | 4,480    | 3,508  | 1.70   | 2               | $1\frac{11}{16}$ | $\frac{3}{4}$   | $2\frac{11}{32}$ | $1\frac{15}{16}$ | 1               | $1\frac{3}{4}$ | 2              |
| 1              | 5,900    | 4,620  | 1.70   |                 |                  |                 |                  |                  |                 |                |                |
| $1\frac{1}{4}$ | 9,500    | 7,440  | 3.60   | $2\frac{1}{2}$  | $1\frac{13}{16}$ | 1               | $3\frac{3}{8}$   | $2\frac{3}{8}$   | $1\frac{1}{4}$  | $2\frac{1}{4}$ | 3              |
| $1\frac{1}{2}$ | 13,800   | 10,807 | 3.50   |                 |                  |                 |                  |                  |                 |                |                |
| $1\frac{3}{4}$ | 18,600   | 14,566 | 16.40  | 4               | 4                | $1\frac{1}{2}$  | $6\frac{1}{4}$   | 4                | $2\frac{1}{4}$  | $3\frac{3}{4}$ | 4              |
| 2              | 24,600   | 19,265 | 15.90  |                 |                  |                 |                  |                  |                 |                |                |
| $2\frac{1}{4}$ | 32,300   | 25,295 | 15.40  |                 |                  |                 |                  |                  |                 |                |                |
| $2\frac{1}{2}$ | 39,800   | 31,169 | 14.90  |                 |                  |                 |                  |                  |                 |                |                |

| PROJECT INFORMATION |  | APPROVAL STAMP                             |  |
|---------------------|--|--|--|
| Project:            |  | <input type="checkbox"/> Approved          |  |
| Address:            |  | <input type="checkbox"/> Approved as noted |  |
| Contractor:         |  | <input type="checkbox"/> Not approved      |  |
| Engineer:           |  | Remarks:                                   |  |
| Submittal Date:     |  |  |  |
| Notes 1:            |  |  |  |
| Notes 2:            |  |  |  |