

## Fig. 212FP

## Seismic Bracing Clamp

**Size Range:** 2 1/2" through 12"

**Material:** Carbon steel

**Finish:**  Plain or  Hot-Dip Galvanized with Zinc Plated Bolts & Nuts

**Service:** For seismic bracing, to be used with Fig. 113 brace fitting. Pipe clamp bolt holes are designed to match holes in brace fitting.

**Maximum Temperature:** Plain 750° F, Galvanized 450° F

**Approvals:** Complies with Federal Specification A-A-1192A (Type 4) *WW-H-171-E (Type 4)*, ANSI/MSS SP-69 and MSS SP-58 (Type 4).

**Installation:** Designed for use with Fig. 113 brace fitting.

**Ordering:** Specify pipe size, figure number, name and finish.

**Note:** The "C" gap dimension should be used at the upper and lower locations to ensure proper installation of the clamp.

**Standard Figure 212 will be furnished for sizes 2 1/2" thru 4".**

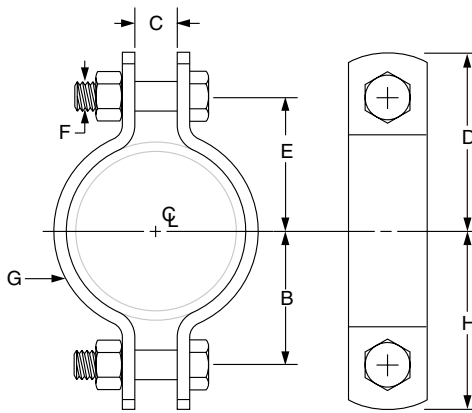

**FIG. 212FP: LOADS (LBS) • WEIGHT (LBS) • DIMENSIONS (IN)**

Pipe Size	Max Load For Service Temp		Weight (lbs)	B	C	Rod Take Out E	H	D	F	G Width
	650° F	750° F								
2 1/2	1,040	930	1.20	2 5/8	5/8	2 5/8	3 1/4	3 1/4	1/2	1
3			1.40	2 7/8		2 7/8	3 1/2	3 1/2		
3 1/2			1.50	3 3/16		3 3/16	3 13/16	3 13/16		
4			1.80	3 1/2		3 1/2	4 1/4	4 1/4		
5			2.50	4 3/16	3/4	4 3/16	4 15/16	4 15/16		1 1/4
6			5.20	4 7/8	1 1/4	4 7/8	5 3/4	5 3/4		1 1/2
8			6.30	6		6	6 7/8	6 7/8		
10			13.60	7 7/16		7 7/16	8 9/16	8 9/16		
12			15.20	8 7/16	1	8 7/16	9 9/16	9 9/16		2

PROJECT INFORMATION		APPROVAL STAMP	
Project:		<input type="checkbox"/> Approved	
Address:		<input type="checkbox"/> Approved as noted	
Contractor:		<input type="checkbox"/> Not approved	
Engineer:		Remarks:	
Submittal Date:			
Notes 1:			
Notes 2:			