

Fig. 108

Split Pipe Ring

Size Range: $\frac{3}{8}$ " through 8"

Material: Malleable iron

Finish: Plain

Service: Recommended for suspension of non-insulated **stationary** pipe lines or conduit. May be used with rod socket Fig. 110R or turnbuckle adjuster Fig. 114.

Maximum Temperature: 450° F

Approvals: Complies with Federal Specification A-A-1192A (Type 11) WW-H-171-E (Type 11), ANSI/MSS SP-69 and MSS SP-58 (Type 11).

Features:

- Permits installation before or after pipe is in place.
- Provides economical installation.
- Permits use of universally adaptable parts.

Ordering: Specify pipe size, figure number, name.

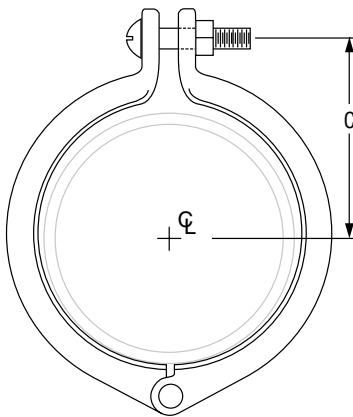

**FIGURE 108:
LOADS (LBS) • WEIGHT (LBS) • DIMENSIONS (IN)**

Pipe Size	Max Load	Weight	C	Bolt Size
$\frac{3}{8}$	200	0.06	$\frac{3}{4}$	#10 x $\frac{7}{8}$
$\frac{1}{2}$		0.09	$\frac{15}{16}$	
$\frac{3}{4}$	300	0.11	$1\frac{1}{8}$	$\frac{1}{4}$ x 1
1		0.13	$1\frac{1}{4}$	
$1\frac{1}{4}$		0.18	$1\frac{9}{16}$	
$1\frac{1}{2}$		0.26	$1\frac{11}{16}$	
2	450	0.33	$2\frac{1}{16}$	$\frac{1}{4}$ x $1\frac{1}{4}$
$2\frac{1}{2}$		0.44	$2\frac{1}{4}$	
3		0.63	$2\frac{3}{4}$	
$3\frac{1}{2}$		0.81	$3\frac{1}{8}$	
4	520	0.97	$3\frac{5}{8}$	$\frac{3}{8}$ x 2
5		1.50	$4\frac{1}{2}$	
6	1,300	2.60	$5\frac{7}{16}$	$\frac{1}{2}$ x 2
8	1,800	5.20	$6\frac{3}{8}$	

PROJECT INFORMATION		APPROVAL STAMP	
Project:		<input type="checkbox"/> Approved	
Address:		<input type="checkbox"/> Approved as noted	
Contractor:		<input type="checkbox"/> Not approved	
Engineer:		Remarks:	
Submittal Date:			
Notes 1:			
Notes 2:			