

FIG. 7091

Gruvlok® DI-LOK™ CTS Groove x IPS Groove Dielectric Fitting

The Gruvlok Fig. 7091 DI-LOK Fitting prevents the formation of a galvanic cell between grooved end steel pipe and copper tube. The separation of copper from steel by the fitting virtually eliminates the galvanic cell created by the dissimilar metals.

The DI-LOK Fitting is designed for use at temperatures from -40°F to 230°F (-40°C to 110°C) and pressures to 300 psig (20.7 bar) in a wide range of applications.



MATERIAL SPECIFICATIONS

HOUSING: Seamless Carbon Steel to ASTM A106

COATING: Nylon conforming to ANSI/NSF-61

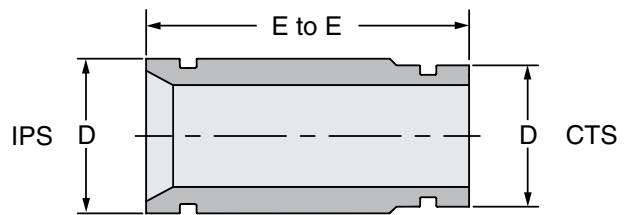

FIGURE 7091 DI-LOK NIPPLE				
Nominal Size	Copper (CTS)	Steel (IPS)	End to End	Approx. Wt. Ea.
	D Actual	D Actual		
<i>IPS</i>	<i>In./mm</i>	<i>In./mm</i>	<i>In./mm</i>	<i>Lbs./Kg</i>
2	2.125 53.98	2.375 60.33	4.0 101.60	1.76 0.80
2½	2.625 66.68	2.875 73.03	6.0 152.40	3.66 1.66
3	3.125 79.38	3.500 88.90	6.0 152.40	5.23 2.37
4	4.125 104.78	4.500 114.30	6.0 152.40	6.88 3.12
6	6.125 155.58	6.625 168.28	6.0 152.40	13.80 6.26
8	8.125 206.38	8.625 219.07	6.0 152.40	18.91 8.58

For installation and assembly of grooved-end connections, see "Fig. 6400 Gruvlok Rigid Coupling", "Fig. 7400 Gruvlok Rigidlite Coupling" and "Fig. 7012 Gruvlok Flange".

PROJECT INFORMATION		APPROVAL STAMP
Project:		<input type="checkbox"/> Approved
Address:		<input type="checkbox"/> Approved as noted
Contractor:		<input type="checkbox"/> Not approved
Engineer:		Remarks:
Submittal Date:		
Notes 1:		
Notes 2:		