

## Class 300 (XS/XH)

# FIG. 3163

## Cap

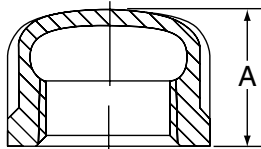

For Listings/Approval Details and Limitations, visit our website at [www.anvilintl.com](http://www.anvilintl.com) or contact an Anvil® Sales Representative.

### FIGURE 3163 - CAP

Nominal Size	Dimension A	Approx. Wt. Each
<i>In. (mm)</i>	<i>In. (mm)</i>	<i>Lbs. (kg)</i>
1/4	0.78	0.10
8	19.81	0.05
3/8	0.81	0.15
10	20.57	0.07
1/2	1.00	0.23
15	25.40	0.10
3/4	1.06	0.35
20	26.92	0.16
1	1.25	0.58
25	31.75	0.26
1 1/4	1.38	0.94
32	35.05	0.43
1 1/2	1.44	1.20
40	36.58	0.54
2	1.69	1.90
50	42.93	0.86
2 1/2	2.06	3.30
65	52.32	1.50
3	2.19	4.70
80	55.63	2.13

### MATERIAL SPECIFICATIONS

Dimensions: Fittings: ASME B16.3  
 Unions: ASME B16.39  
 Bushings/Plugs: ASME B16.14

Material: ASTM A-197

Finish: Black or Hot Dip Galvanized per ASTM A153 Class A

Threads: NPT per ASME B1.20.1

Pressure Ratings: Fittings: ASME B16.3  
 Unions: ASME B16.39  
 Bushings/Plugs: ASME B16.14

Pressure Testing: All malleable iron fittings are tested for through wall porosity using an air under water process.

Agency Approvals: All malleable iron fittings and unions are UL/ULC Listed and FM Approved.

### PROJECT INFORMATION

### APPROVAL STAMP

Project:	<input type="checkbox"/> Approved
Address:	<input type="checkbox"/> Approved as noted
Contractor:	<input type="checkbox"/> Not approved
Engineer:	Remarks:
Submittal Date:	
Notes 1:	
Notes 2:	