



ANMIL[®]
INTERNATIONAL, INC.
(Formerly Grinnell)



Figure 3306N Hydraulic Snubber
The true replacement for PSA Snubbers

Hydraulic Snubber *FIGURE 3306N SIZES 1/4 - 35*

Anvil's Figure 3306N Hydraulic Snubbers are designed as direct replacements for Pacific Scientific PSA-1/4 through PSA-35 mechanical snubbers.

The Fig. 3306N incorporates the same reliable seals, materials, fluid, and valve design as our widely used Fig. 200N Hydraulic Snubbers. Therefore, they offer proven reliability.

The Fig. 3307N is the Fig. 3306N with an extension piece.



Applications

- Direct replacement of PSA snubbers: Exact load ratings, exact pin sizes, exact stroke lengths, and exact pin-to-pin dimensions make the Fig. 3306N an exact replacement for the PSA mechanical snubbers. Additionally, the cross sectional dimensions of the 3306N are based on those of the PSA to facilitate non-interference one-to-one replacement. Pins, clamps, pivot mounts, extension pieces, and rear brackets used with PSA snubbers are compatible with the Fig. 3306N and can be utilized at your discretion.
- New Installations: For new installations, including ASME Subsection NF, the 3306N is available with a complete line of pipe clamps and rear brackets.

Design Features

- Compact Design: Fits into existing envelopes.
- Interchangeable Parts: Existing PSA attachments may be used at your discretion.
- Functional and Dynamic Qualification: Qualification is to the proposed ASME QME/QDR standard for dynamic restraints.
- Drag Force: The drag force does not exceed 2% of rated load (17½ lbs. minimum).

Ethylene-Propylene Seals and SF-1154 Fluid

- All seals and fluid are radiation resistant to 3×10^7 Rads
- All seals and fluid have a 25 year Service Life at 157°F.

Temperature

- 200°F continuous.
- 300°F maximum LOCA.

Pressurized Reservoir

- Insures positive fluid pressure regardless of snubber orientation.
- Fluid level can be visually inspected.
- Exact fluid level can be measured.



Temperature Compensating Control Valves

- Temperature compensating locking velocity and bleed rates eliminate the need for a narrow range of functional test acceptance criteria.
- The bleed valve incorporates a multi-orifice design with proven resistance to clogging.
- The tamper-proof lock-up and bleed valves are precalibrated to any specified setting.

Finish

The finish is corrosion resistant, and non-reactive to Boron spray.

Advantages

- The only exact replacement for PSA snubbers, designed for non-interference installation.
- Qualification to anticipated new functional and dynamic requirements.
- Superior drag characteristics.
- Longer service life.
- Higher radiation and temperature resistance.
- Exact fluid level measurement when more than a visual examination is required.
- Temperature compensating valves.
- Reduced weight.

Benefits

- Ease of installation reduces costs and radiation exposure when replacing existing snubbers.
- Enhanced qualification program eliminates concerns over future changes to functional and dynamic requirements for snubbers.

ANVIL[®]
INTERNATIONAL, INC.

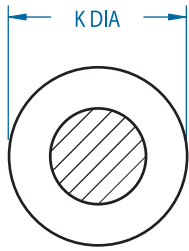

Bolt plate dia. K
Section x-x
Size 1/4 to 10

Fig. 3306N
Size 1/4 to 10

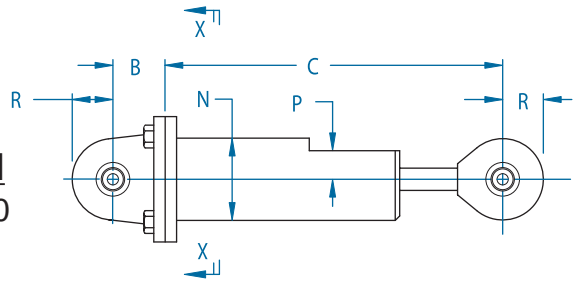

Fig. 3307N
Size 1/4 to 10

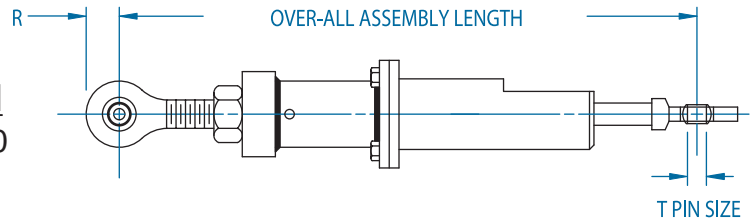

Fig. 3306N
Size 35

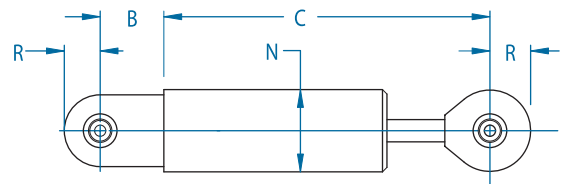
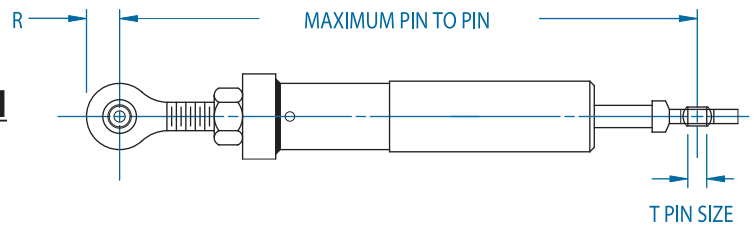

Fig. 3307N
Size 35



Units, Inches and Pounds

Snubber Size	Stroke	Design Load	B	C Min.	C Max.	K Dia.	P	N Dia.	R Max	T Dia. (Ref.)	Max. Pin-Pin
1/4	4.00	350	1.19	9.00	13.00	2.25	.62	2.25	.63	3/8	61.50
1/2	2.50	650		7.50	10.00						
1	4.00	1500	1.56	11.00	15.00	3.25	.69	2.38	1.00	1/2	61.50
		8.00		1487	15.50						
3	5.00	6000	2.12	14.50	19.50	4.62	1.44	4.62	1.38	3/4	61.50
		10.00		6000	20.50						
10	6.00	15000	3.06	17.10	23.10	5.75	1.62	5.75	1.62	1	72.75
		12.00		14400	24.10						
35	6.00	50000	3.00	24.00	30.00	-	-	6.00	3.00	1 1/2	117.50

ENGINEERED PIPE SUPPORTS

*Your Complete Source
for Engineered Pipe Supports*

Special Fabrications:

Fabricated Steel • Clamps
Seismic Restraints
Special Paint Applications
Pipe Support Design
ISO-9001 & NF Approved Services
Field Service Assistance

Send Inquiries to:

Precision Park • 160 Frenchtown Road
North Kingstown, RI 02852
Phone: 401-886-3001
Fax: 401-886-3053

24 HOUR SHIPMENT

of Standard Variable Spring Supports,
Associated Stock Hardware
(Clevises, Eye Nuts, All Thread Rods
and Structural Attachments)

From North Kingstown, RI
Engineered Pipe Support Plant

CALL CUSTOMER SERVICE

Phone: 401-886-3025
Fax: 401-886-3056

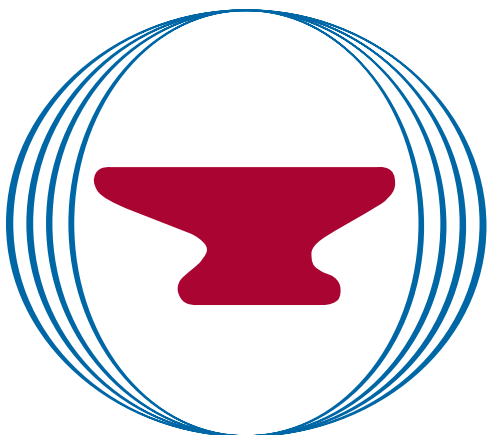

REGIONAL SERVICE CENTERS

Georgia

6344 Cash Court • Norcross, GA 30071
Tel: 770-662-8177 • Fax: 770-662-0284
Tom Ward – Regional Vice President

Illinois

750 Central Avenue • University Park, IL 60466
Tel: 708-534-1414 • Fax: 708-534-5441
Toll Free: 1-800-301-2701
Dean Taylor – Regional Vice President

Nevada

1385 Greg Street • Sparks, NV 89431
Tel: 775-353-7366 • Fax: 775-331-2810
Shipping/Receiving Fax: 775-331-3645
Bob Arison – Regional Vice President

Pennsylvania

2530 Pearl Buck Road • Bristol, PA 19007
Tel: 215-788-4056 • Fax: 215-788-4475
Tom Ward – Regional Vice President

Texas

1313 Avenue R • Grand Prairie, TX 75050
Tel: 972-343-9206 • Fax: 972-641-8946
Bob Arison – Regional Vice President

Canada – Mueller-Flow Control

Kevin Fullan – Vice President • 416-251-4171

Anvil Corporate Office

110 Corporate Drive, Suite 10 • P.O. Box 3180
Portsmouth, NH 03802-3180
Tel: 603-422-8000 • Fax: 603-422-8033
E-mail Address: webmaster@anvilintl.com
www.anvilintl.com

ANVIL®
INTERNATIONAL, INC.