



## **GRUVLOK® SPECIALTY PRODUCTS**

Price Sheet GR.SP-7.12 | Effective: July 2, 2012 | Cancels Price Sheet GR.SP-10.11 of October 3, 2011

**FOR THE MOST CURRENT PRODUCT/PRICING INFORMATION ON ANVIL PRODUCTS,  
PLEASE VISIT OUR WEBSITE AT [WWW.ANVILINTL.COM](http://WWW.ANVILINTL.COM)**

### **FREIGHT ALLOWANCE:**

All prices are F.O.B. point of shipment. On shipments weighing 2,500 pounds or more, rail freight or motor freight at the lowest published rate, is allowed to all continental U.S. rail points or all U.S. highway points listed in published tariffs (Alaska and Hawaii excluded). In no case will more than actual freight be allowed.

### **NOTE:**

All orders are accepted on the basis of prices in effect at the time of shipment.

### **NOTICE:**

To the prices and terms quoted, there will be added any manufacturers or sales tax payable on the transaction under any effective statute.

### **GENERAL**

- UPC numbers are available upon request.
- To obtain current ISO certifications, listings, and other approvals, visit Anvil's Web site at [www.anvilintl.com](http://www.anvilintl.com).
- Pricing is subject to change without notice. Go to Anvil's Web site for the most current list price information, or contact your local Anvil representative.

### **LOSS OR DAMAGE CLAIMS:**

All goods are shipped at buyer's risk. Shipments should be carefully examined upon delivery and before the carrier's delivery receipt is signed. If any loss or damage is evident, the buyer should make an appropriate notation on the delivery receipt and insist that the carrier's driver initial such exception. The contents of all packages should be carefully examined for concealed damage as soon as possible after delivery, so that the carrier can be requested, within 48 hours after delivery, to arrange for prompt inspection of the damaged goods.

**NORTHERN REGION  
CUSTOMER SERVICE CENTER  
800-301-2701**

**SOUTHERN REGION  
CUSTOMER SERVICE CENTER  
800-451-4414**

[www.anvilintl.com](http://www.anvilintl.com)

## 1. CONTROLLING PROVISIONS:

These terms and conditions shall control with respect to any purchase order or sale of Seller's products. No waiver, alteration or modification of these terms and conditions whether on Buyer's purchase order or otherwise shall be valid unless the waiver, alteration or modification is specifically accepted in writing and signed by an authorized representative of Seller.

## 2. DELIVERY:

Seller will make every effort to complete delivery of products as indicated on Seller's acceptance of an order, but Seller assumes no responsibility or liability, and will accept no backcharge, for loss or damage due to delay or inability to deliver caused by acts of God, war, labor difficulties, accident, delays of carriers, by contractors or suppliers, inability to obtain materials, shortages of fuel and energy, or any other causes of any kind whatever beyond the control of Seller. Seller may terminate any contract of sale of its products without liability of any nature, by written notice to Buyer, in the event that the delay in delivery or performance resulting from any of the aforesaid causes shall continue for a period of sixty (60) days. Under no circumstances shall Seller be liable for any special or consequential damages or for loss, damage, or expense (whether or not based on negligence) directly or indirectly arising from delays or failure to give notice of delay.

## 3. WARRANTY:

Seller warrants for one year from the date of shipment Seller's manufactured products to the extent that Seller will replace those having defects in material or workmanship when used for the purpose and in the manner which Seller recommends. If Seller examination shall disclose to its satisfaction that the products are defective, and an adjustment is required, the amount of such adjustment shall not exceed the net sales price of the defective products only and no allowance will be made for labor or expense of repairing or replacing defective products or workmanship of damage resulting from the same. Seller warrants the products which it sells of other manufacturers to the extent of the warranties of their respective makers. Where engineering design or fabrication work is supplied. Buyer's acceptance of Seller's design or of delivery of work shall relieve Seller of all further obligation, other than expressed in Seller's product warranty. THIS IS SELLER'S SOLE WARRANTY. SELLER MAKES NO OTHER WARRANTY OF ANY KIND, EXPRESSED OR IMPLIED AND ALL IMPLIED WARRANTIES OF MERCHANTABILITY AND FOR A PARTICULAR PURPOSE WHICH EXCEED SELLER'S AFORESTATED OBLIGATION ARE HEREBY DISCLAIMED BY SELLER AND EXCLUDED FROM THIS WARRANTY. Seller neither assumes, nor authorizes any person to assume for it, any other obligation in connection with the sale of its engineering designs or products. This warranty shall not apply to any products or parts of products which (a) have been repaired or altered outside of Seller's factory, in any manner; (b) have been subjected to misuse, negligence or accidents; (c) have been used in a manner contrary to Seller's instructions or recommendations. Seller shall not be responsible for design errors due to inaccurate or incomplete information supplied by Buyer or its representatives.

## 4. SELLER'S LIABILITY:

Seller will not be liable for any loss, damage, cost of repairs, incidental or consequential damages of any kind, whether based upon warranty (except for the obligation accepted by Seller under "Warranty" above), contract or negligence, arising in connection with the design, manufacture, sale, use or repair of the products or of the engineering designs supplied to Buyer.

## 5. RETURNS:

Seller cannot accept return of any products unless its written permission has been first obtained, in which case same will be credited subject to the following (a) All material returned must, on its arrival at Seller's Plant, be found to be in first-class condition; if not, cost of putting in saleable condition will be deducted from credit memoranda; (b) A handling charge deduction of twenty percent (20%) will be made from all credit memoranda issued for material returned; (c) Transportation charges, if not prepaid will be deducted from credit memoranda.

## 6. SHIPMENTS:

All products sent out will be carefully examined, counted and packed. The cost of any special packing or special handling caused by Buyer's requirements or requests shall be added to the amount of the order. No claim for shortages will be allowed unless made in writing within ten (10) days of receipt of a shipment.

Claims for products damaged or lost in transit should be made on the carrier, as Seller's responsibility ceases, and title passes, on delivery to the carrier.

## 7. SPECIAL PRODUCTS:

Orders covering special or nonstandard products are not subject to cancellation except on such terms as Seller may specify on application.

## 8. PRICES AND DESIGNS:

Prices and designs are subject to change without notice. All prices are F.O.B. Point of shipment, unless otherwise stated.

## 9. TAXES:

The amount of any sales, excise or other taxes, if any, applicable to the products covered by this order, shall be paid by Buyer unless Buyer provides Seller with an exemption certificate acceptance to the taxing authorities.

## 10. NUCLEAR PLANTS:

Where the products, engineering design or fabrication is for nuclear plant applications. Buyer agrees (a) to take all necessary steps to add Seller as an insured under the American Nuclear Insurers' (ANI) pool and under the Mutual Atomic Energy Reinsurance Pool (MAERP) for property damage and liability insurance and if necessary steps could have been taken, but are not taken, Buyer shall hold Seller harmless against all such losses which could have been thus covered (b) Buyer agrees to hold Seller harmless with respect to any personal injury (or death), property damage or other loss in a nuclear incident which is caused directly or indirectly by defective design, material, workmanship furnished by Buyer (or which could be so covered but with respect to which Buyer has elected to self-insure), and further agrees to waive subrogation by its carriers of such insurance against Seller, and (c) as to nuclear hazards for which Buyer cannot obtain insurance coverage, the liability of Seller for any personal injury (or death), property damage or other loss directly caused by defective design, material, or workmanship furnished by Seller shall not exceed the value at the time of the loss occurrence.

## 11. MINIMUM INVOICE:

Domestic: \$100 plus transportation.  
International: \$500 plus transportation.

## 12. TERMS:

Cash, net 30 days unless otherwise specified.

NOTE: All orders are accepted on the basis of prices in effect at the time of shipment.

NOTICE: The prices and terms quoted, there will be added any manufacturers or sales tax payable on the transaction under any effective statute.

FREIGHT ALLOWANCE: All prices are F.O.B. point of shipment. On shipments weighing 2,500 pounds or more, rail freight or motor freight at the lowest published rate, is allowed to all continental U.S. rail points or all U.S. highway points listed in published tariffs (Alaska and Hawaii excluded). In no case will more than actual freight be allowed. Shipments (weighing less than 2,500 pounds) will be shipped prepaid. The buyer will be invoiced for freight costs at the applicable published class, exception or commodity rate(s) or charge(s). Anvil reserves the right to select the carrier for all shipments.

## Table of Contents

<b>Terms and Conditions</b> .....	<b>2</b>
Fig. 758G Grooved-End “WYE” Strainer .....	4
<b>Fittings for Grooved-End Pipe</b> .....	<b>4</b>
90° Adapter Elbows Fig. 7055 .....	4
45° Adapter Elbows Fig. 7056 .....	4
Reducing Tee Wyes Fig. 7067 .....	4
Steel Swaged Nipples Figs. 7077, 7078, and 7079 .....	5
Adapter Nipples Figs. 7080F, 7081F, and 7082F .....	5
<b>Extra Heavy “EG” End Guard Fittings</b> .....	<b>6</b>
Header Tee Fig. 7662EG .....	6
90° Elbows Fig. 7050EG .....	6
45° Elbows Fig. 7051EG .....	6
Tee Fig. 7060EG .....	6
<b>Plain-End Fittings (For use with Fig. 7005 Coupling only)</b> .....	<b>7</b>
90° Elbows Fig. 7050P .....	7
90° Long Radius Elbows Fig. 7050LRP .....	7
45° Elbows Fig. 7051P .....	7
45° Long Radius Elbows Fig. 7051LRP .....	7
Tee Fig. 7060P .....	7
Cross Fig. 7068P .....	7
Lateral Fig. 7069P .....	7
True WYE Fig. 7071P .....	7
Bull Plug Fig. 7075P .....	7
Fabricated Steel Reducing Tees Fig. 7061P .....	8
Lubricants .....	9
Cross Reference .....	10

**Fig. 758G**  
**Grooved-End**  
**“WYE” Strainer**

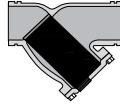

NOMINAL PIPE SIZE (INCHES)	APPROX. WEIGHT EACH (LBS)	LIST PRICES		QTY.
		PAINTED	GALV.	
2	12.00	\$1,348.50	\$1,507.25	-
2½	18.00	\$1,415.50	\$1,604.50	-
3	23.00	\$1,590.50	\$1,828.50	-
4	42.00	\$1,800.50	\$2,128.75	-
5	80.00	\$2,606.25	\$3,105.75	-
6	112.00	\$2,829.25	\$3,481.50	-
8	205.00	\$4,336.25	\$5,428.75	-
10	277.00	\$6,970.50	\$8,751.25	-
12	470.00	\$12,176.00	\$14,797.75	-

## Fittings for Grooved-End Pipe

**90° Adapter Elbows**  
**Fig. 7055**



For listing/approval details contact your Gruvlok Representative.

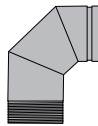

NOMINAL PIPE SIZE (INCHES)	APPROX. WEIGHT EACH (LBS)	LIST PRICES		QTY.
		PAINTED	GALV.	
1	0.60	\$122.25	\$151.75	-
1¼	1.00	\$136.75	\$151.75	-
1½	1.20	\$174.50	\$202.50	-
2	2.30	\$122.25	\$151.75	-
2½	3.70	\$212.25	\$232.25	-
3	6.50	\$196.75	\$241.50	-
4	11.00	\$408.25	\$489.25	-
6	19.80	\$609.75	\$771.75	-

Gruvlok Adapter Elbows are fabricated steel.

**45° Adapter Elbows**  
**Fig. 7056**



For listing/approval details contact your Gruvlok Representative.

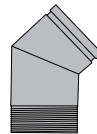

NOMINAL PIPE SIZE (INCHES)	APPROX. WEIGHT EACH (LBS)	LIST PRICES		QTY.
		PAINTED	GALV.	
1	0.60	\$184.25	\$201.50	-
1¼	0.70	\$199.50	\$213.00	-
1½	0.80	\$201.50	\$215.50	-
2	1.60	\$205.25	\$250.75	-
2½	2.20	\$207.50	\$214.50	-
3	4.30	\$354.25	\$379.75	-
4	7.50	\$304.25	\$373.25	-
6	11.10	\$742.50	\$776.75	-

Gruvlok Adapter Elbows are fabricated steel.

**Reducing Tee Wyes**  
**Fig. 7067**



For listing/approval details contact your Gruvlok Representative.

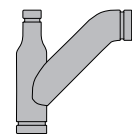

NOMINAL PIPE SIZE RUN (INCHES)	LENGTH (INCHES)	APPR. WEIGHT EACH (LBS.)	LIST PRICES		QTY.
			PAINTED	GALV.	
4x3	x3	16.00	\$1,092.50	\$1,298.75	-
	x4	27.00	\$1,552.50	\$1,861.00	-
5x3	x3	25.00	\$1,476.50	\$1,730.75	-
	x5	44.00	\$2,786.50	\$3,160.25	-
5x4	x3	21.00	\$1,534.75	\$1,729.25	-
	x4	25.00	\$1,762.75	\$1,989.50	-
6x4	x6	61.00	\$3,085.25	\$3,509.50	-
	x3	27.00	\$1,625.00	\$1,849.00	-
6x5	x4	31.00	\$1,883.75	\$2,141.75	-
	x4	45.00	\$2,861.00	\$3,471.25	-
8x6	x8	95.00	\$4,373.00	\$5,059.50	-

Gruvlok Reducing Laterals are fabricated steel.  
Additional sizes priced upon request.

## Steel Swaged Nipples

### Figs. 7077, 7078, and 7079

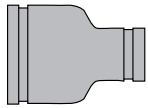

Fig. 7077  
GR x GR

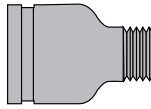

Fig. 7078  
GR x THD

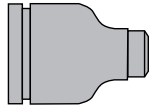

Fig. 7079  
GR x BEV

NOMINAL PIPE SIZE (INCHES)		APPROX. WEIGHT EACH (LBS)	PRICE EACH PAINTED	QTY.
2	x 1	2.00	\$277.75	-
	x 1¼	2.00	\$277.75	-
	x 1½	2.00	\$277.75	-
2½	x 1	3.50	\$277.75	-
	x 1¼	3.50	\$277.75	-
	x 1½	3.50	\$277.75	-
	x 2	3.50	\$239.25	-
3	x 1	5.00	\$350.00	-
	x 1¼	5.00	\$350.00	-
	x 1½	5.00	\$350.00	-
	x 2	5.00	\$261.00	-
	x 2½	5.00	\$261.00	-
3½	x 3	7.00	\$311.25	-
4	x 1	8.00	\$474.75	-
	x 1¼	8.00	\$474.75	-
	x 1½	8.00	\$474.75	-
	x 2	8.00	\$359.75	-
	x 2½	8.00	\$359.75	-
	x 3	8.00	\$359.75	-
	x 3½	8.00	\$359.75	-
5	x 2	12.00	\$1,315.00	-
	x 2½	12.00	\$1,315.00	-
	x 3	12.00	\$1,016.50	-
	x 4	12.00	\$836.50	-
6	x 1	19.00	\$2,504.00	-
	x 1¼	19.00	\$2,504.00	-
	x 1½	19.00	\$2,504.00	-
	x 2	19.00	\$1,852.75	-
	x 2½	19.00	\$1,852.75	-
	x 3	19.00	\$1,201.50	-
	x 3½	19.00	\$1,201.50	-
	x 4	19.00	\$912.75	-
x 5	19.00	\$912.75	-	

Made of carbon steel conforming to ASTM A106.

## Adapter Nipples

### Figs. 7080F, 7081F, and 7082F

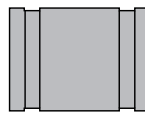

Fig. 7080F  
GR x GR

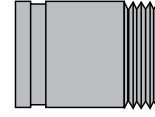

Fig. 7081F  
GR x MPT

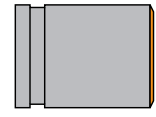

Fig. 7082F  
GR x BEV

NOMINAL PIPE SIZE (INCHES)	PRICE PER LENGTH - (INCHES)				
	4	6	8	10	12
¾	\$42.75	\$65.00	\$77.25	\$89.25	\$101.00
1	\$42.75	\$67.50	\$77.25	\$89.25	\$101.00
1¼	\$42.75	\$67.50	\$77.25	\$89.25	\$101.00
1½	\$42.75	\$67.50	\$78.50	\$89.75	\$102.75
2	\$42.75	\$67.50	\$78.50	\$89.75	\$102.75
2½	\$49.25	\$90.25	\$90.25	\$105.50	\$120.00
3	\$60.00	\$97.25	\$117.25	\$136.75	\$155.75
4	\$98.50	\$98.50	\$162.00	\$190.75	\$219.25
5	\$203.25	\$203.25	\$283.00	\$349.50	\$402.00
6	\$261.00	\$261.00	\$337.00	\$391.50	\$445.00
8	\$292.25	\$292.25	\$389.00	\$533.75	\$600.00
10	\$392.25	\$394.75	\$425.00	\$656.25	\$780.50
12	\$438.25	\$533.00	\$533.00	\$830.75	\$989.50

Unless otherwise specified, Adapter Nipples for nominal pipe sizes 6" and smaller are made from Schedule 40 pipe; for nominal sizes 8" and larger, from Schedule 30 pipe.

For Galvanized pricing, add 50% to list price.

Special lengths, heavier wall thickness, and electroplated nipples are priced on application.

Adapters not shown are available from JB Smith; contact Anvil for availability.

## Extra Heavy "EG" End Guard Fittings

### Header Tee Fig. 7662EG

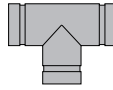

NOMINAL PIPE SIZE (INCHES)	CENTER TO END (INCHES)	APPROX. WEIGHT EACH (LBS)	PRICE EACH	QTY.
2	6.5	4.90	\$601.00	-
2	5.0	3.60	\$575.75	-

Specify choice on order.  
Gruvlok Header Tees are fabricated steel.

### 90° Elbows Fig. 7050EG



NOMINAL PIPE SIZE (INCHES)	CENTER TO END (INCHES)	APPROX. WEIGHT EACH (LBS)	PRICE EACH	QTY.
2	3.25	2.50	\$309.00	-
2½	3.75	4.20	\$427.75	-
3	4.25	6.00	\$326.25	-
4	5.00	11.00	\$432.75	-
6	6.5	27.20	\$1,586.00	-

Gruvlok Elbows are fabricated steel.

### 45° Elbows Fig. 7051EG

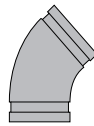

NOMINAL PIPE SIZE (INCHES)	CENTER TO END (INCHES)	APPROX. WEIGHT EACH (LBS)	PRICE EACH	QTY.
2	2.00	1.80	\$403.50	-
2½	2.25	2.90	\$403.50	-
3	2.50	4.30	\$403.50	-
4	3.00	7.50	\$535.25	-
6	3.50	16.50	\$862.00	-

Gruvlok Elbows are fabricated steel.

### Tee Fig. 7060EG

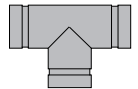

NOMINAL PIPE SIZE (INCHES)	CENTER TO END (INCHES)	APPROX. WEIGHT EACH (LBS)	PRICE EACH	QTY.
2	3.25	3.30	\$514.25	-
2½	3.75	5.10	\$648.75	-
3	4.25	9.30	\$697.25	-
4	5.00	15.90	\$796.50	-
6	6.50	38.50	\$1,678.00	-

Gruvlok Tees are fabricated steel.

## Plain-End Fittings (For use with Fig. 7005 Coupling only)

### 90° Elbows Fig. 7050P



NOMINAL PIPE SIZE (INCHES)	APPROX. WEIGHT EACH (LBS)	PRICE EACH		QTY.
		PAINTED	GALV.	
2	2.70	\$439.75	\$485.00	-
2½	4.80	\$514.75	\$572.50	-
3	7.20	\$534.25	\$598.00	-
3½	-	POA	POA	-
4	12.30	\$605.50	\$666.00	-
5	13.40	\$695.75	\$1,396.50	-
6	31.00	\$879.75	\$1,071.00	-
8	38.70	\$1,653.00	\$1,868.50	-

Plain-End Fittings are manufactured from fabricated steel. Other sizes available. Priced on application. **Plain-End Fittings (For use with 7005 Coupling only)**

### 90° Long Radius Elbows Fig. 7050LRP

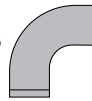

NOMINAL PIPE SIZE (INCHES)	APPROX. WEIGHT EACH (LBS)	PRICE EACH		QTY.
		PAINTED	GALV.	
2	2.50	\$453.75	\$500.25	-
2½	4.90	\$530.50	\$589.75	-
3	6.50	\$551.00	\$616.25	-
4	11.50	\$624.25	\$687.50	-
5	21.50	\$717.25	\$1,442.00	-
6	28.50	\$909.00	\$1,105.50	-
8	56.70	\$1,646.00	\$1,929.50	-

### 45° Elbows Fig. 7051P

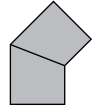

NOMINAL PIPE SIZE (INCHES)	APPROX. WEIGHT EACH (LBS)	PRICE EACH		QTY.
		PAINTED	GALV.	
2	2.00	\$466.25	\$573.50	-
2½	3.50	\$466.25	\$573.50	-
3	4.80	\$534.25	\$601.75	-
3½	-	POA	POA	-
4	8.00	\$556.75	\$616.75	-
5	9.20	\$695.75	\$818.75	-
6	18.50	\$797.25	\$936.50	-
8	24.90	\$934.75	\$1,320.00	-

Plain-End Fittings are manufactured from fabricated steel. Other sizes available. Priced on application. **Plain-End Fittings (For use with 7005 Coupling only)**

### 45° Long Radius Elbows Fig. 7051LRP

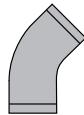

NOMINAL PIPE SIZE (INCHES)	APPROX. WEIGHT EACH (LBS)	PRICE EACH		QTY.
		PAINTED	GALV.	
2	1.80	\$481.75	\$591.50	-
2½	3.60	\$481.75	\$591.50	-
3	4.50	\$552.50	\$591.50	-
4	7.50	\$576.25	\$635.75	-
5	13.70	\$721.50	\$844.75	-
6	17.30	\$826.75	\$967.25	-
8	34.00	\$969.00	\$1,363.50	-

### Tee Fig. 7060P



NOMINAL PIPE SIZE (INCHES)	APPROX. WEIGHT EACH (LBS)	PRICE EACH		QTY.
		PAINTED	GALV.	
2	3.50	\$358.75	\$402.50	-
2½	6.20	\$467.75	\$530.50	-
3	8.60	\$719.50	\$822.00	-
3½	-	POA	POA	-
4	13.80	\$1,030.50	\$1,289.00	-
5	21.70	\$1,409.50	\$1,672.50	-
6	30.90	\$1,227.00	\$1,408.50	-
8	61.10	\$1,768.50	\$2,106.75	-

Plain-End Fittings are manufactured from fabricated steel. Other sizes available. Priced on application. **Plain-End Fittings (For use with 7005 Coupling only)**

### Cross Fig. 7068P

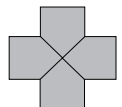

NOMINAL PIPE SIZE (INCHES)	APPROX. WEIGHT EACH (LBS)	PRICE EACH		QTY.
		PAINTED	GALV.	
2	4.40	\$542.25	\$682.25	-
2½	7.80	\$542.25	\$682.25	-
3	10.70	\$643.25	\$727.00	-
4	17.00	\$883.50	\$993.75	-
5	26.70	\$1,254.50	\$1,478.00	-
6	37.70	\$1,655.75	\$2,005.25	-
8	74.60	\$2,124.50	\$2,593.75	-

### Lateral Fig. 7069P

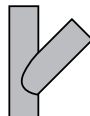

NOMINAL PIPE SIZE (INCHES)	APPROX. WEIGHT EACH (LBS)	PRICE EACH		QTY.
		PAINTED	GALV.	
2	5.10	\$485.00	\$589.25	-
2½	9.50	\$558.00	\$656.25	-
3	12.80	\$662.75	\$778.75	-
3½	-	POA	POA	-
4	22.20	\$912.25	\$1,021.75	-
5	38.00	\$1,548.25	\$1,838.25	-
6	54.00	\$1,597.50	\$1,938.25	-
8	92.00	\$2,680.75	\$3,156.50	-

Plain-End Fittings are manufactured from fabricated steel. Other sizes available. Priced on application. **Plain-End Fittings (For use with 7005 Coupling only)**

### True WYE Fig. 7071P

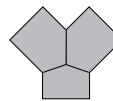

NOMINAL PIPE SIZE (INCHES)	APPROX. WEIGHT EACH (LBS)	PRICE EACH		QTY.
		PAINTED	GALV.	
2	3.50	\$477.50	\$537.50	-
2½	6.20	\$477.50	\$537.50	-
3	8.50	\$536.25	\$613.50	-
3½	-	POA	POA	-
4	14.00	\$795.50	\$916.00	-
5	21.60	\$968.25	\$1,137.25	-
6	31.20	\$1,332.75	\$1,573.75	-
8	53.60	\$1,726.00	\$2,105.50	-

### Bull Plug Fig. 7075P

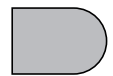

NOMINAL PIPE SIZE (INCHES)	APPROX. WEIGHT EACH (LBS)	PRICE EACH	QTY.
2	2.30	\$251.25	-
2½	3.00	\$251.25	-
3	4.50	\$366.75	-
4	7.50	\$473.25	-
5	12.50	\$832.25	-
6	17.00	\$1,110.25	-
8	29.00	\$2,085.50	-

**Fabricated Steel  
Reducing Tees  
Fig. 7061P**

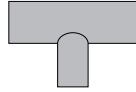

NOMINAL PIPE SIZE (INCHES)	BRANCH (INCHES)	APRX. WEIGHT EACH (LBS.)	LIST PRICES		QTY.
			BLACK	GALV.	
3x3	x2	7.10	\$322.00	\$715.50	-
4x4	x2	11.30	\$445.00	\$555.25	-
	x2½	11.60	\$458.00	\$568.75	-
	x3	11.90	\$458.00	\$572.50	-
6x6	x2	24.60	\$779.25	\$953.25	-
	x3	25.40	\$823.00	\$1,003.00	-
	x4	26.20	\$823.00	\$1,003.50	-
8x8	x2	42.00	\$1,001.75	\$1,278.25	-
	x3	44.00	\$1,050.00	\$1,338.75	-
	x4	46.00	\$886.25	\$1,349.50	-
	x5	48.00	\$1,097.50	\$1,409.50	-
	x6	50.00	\$1,038.50	\$1,419.25	-
10x10	x4	74.00	\$1,641.75	\$2,050.00	-
	x6	78.00	\$1,668.75	\$2,171.00	-
	x8	86.00	\$1,668.75	\$2,211.00	-
12x12	x6	112.00	\$2,427.50	\$3,149.50	-
	x8	118.00	\$2,434.00	\$3,180.75	-
	x10	130.00	\$2,523.50	\$3,342.25	-



## Standard Gaskets – Your order must specify gasket grade

GRADE	TEMPERATURE RANGE	COMPOUND	COLOR CODE	*GENERAL SERVICE APPLICATION
E	-40°F to +230°F	EPDM	Green	Water, dilute acids, alkalis, salts, and many chemical services not involving hydrocarbons, oils, or gases. Excellent oxidation resistance. NOT FOR USE WITH HYDROCARBONS.
T	-20°F to +180°F	Nitrile (Buna-N)	Orange	Petroleum products, vegetable oils, mineral oils, and air contaminated with petroleum oils. NOT FOR USE IN HOT WATER SERVICES.

## Special Gaskets

GRADE	TEMPERATURE RANGE	COMPOUND	COLOR CODE	*GENERAL SERVICE APPLICATION
O	-20°F to +300°F	Fluoro Elastomer	Blue	High-temperature resistance to oxidizing acids, petroleum oils, hydraulic fluids, halogenated hydrocarbons, and lubricants.
L	-40°F to +350°F	Silicone	Red Gasket	Dry, hot air, and some high-temperature chemical services.
E (type A)	-40°F to +150°F	Pre-Lubricated	Violet	Wet and Dry (oil-free air) pipe fire protection sprinkler systems. For dry pipe systems, Gruvlok Xtreme™ Lubricant is required.

**\*Contact Anvil for specific service recommendations. Specify gasket grade when ordering.**  
Use Gruvlok lubricant on gaskets. Check gasket color code to be certain it is recommended for the service intended.  
Additional gasket compounds and configurations are available — contact an Anvil Representative.

LUBRICANTS		STANDARD LUBRICANT USAGE GUIDE			XTREME LUBRICANT USAGE GUIDE	
STANDARD LUBRICANT	PRICE	SIZE OF GASKET	NUMBER OF GASKETS		SIZE OF GASKET	NUMBER OF GASKETS PER QUART
			PER TUBE	PER QUART		
2LB Tub Std Gruvlok Lubricant	\$168.50/tub	2"	55	400	2"	1,200
5 Gallon Pail	\$1,419.75/pail	3"	45	300	3"	900
<b>QUICK DRY LUBRICANT</b>		4"	25	200	4"	600
1 Quart Can	\$181.00	6"	20	130	6"	390
1 Gallon Pail	\$306.25	8"	15	100	8"	300
<b>XTREME LUBRICANT (SILICONE)</b>		10"	10	85	10"	255
10 oz. Tube (1 each)	\$84.25	12"	9	60	12"	180
2.2 lb. Tub (Gruvlok Lubricant)	\$294.00	14"	7	50	14"	150
		16"	6	40	16"	120
		18"	5	35	18"	105
		20"	4	30	20"	90
		24"	3	20	24"	60

## Cross Reference

PRODUCT	GRUVLOK <sup>®</sup>	VICTAULIC <sup>®</sup>
90° Elbow	7050P	10-P
45° Elbow	7051P	11-P
90° Adapter Elbows	7055	18
45° Adapter Elbows	7056	19
Tee	7060P	20-P
Fabricated Steel Reducing Tees	7061P	25-P
Lateral	7069P	30-P
Reducing Tee WYE	7067	32R
True WYE	7071P	33-P
Cross	7068	35
Adapter Nipple – (Gr. x MPT)	7081F	40
Adapter Nipple – (Gr. x Bev)	7082F	42
Adapter Nipple – (Gr. x Gr.)	7080F	43
Steel Swaged Nipple	7077	53
Steel Swaged Nipple	7078	54
Steel Swaged Nipple	7079	55
Bull Plug	7075P	61-P
Extra Heavy “EG” End Guard 90° Elbow	7050 EG	62 ES
Extra Heavy “EG” End Guard 45° Elbow	7051 EG	63 ES
Extra Heavy “EG” End Guard Tee	7060 EG	64 ES

- NOTES -



## CORPORATE OFFICES

110 Corporate Drive, Suite 10  
Portsmouth, NH 03801  
Tel: 603-422-8000 • Fax: 603-422-8033  
E-mail: sales@anvilintl.com

## CUSTOMER SERVICE CENTERS

### UNITED STATES

University Park, IL  
Tel: 708-885-3000 • Fax: 708-534-5441  
Toll Free: 1-800-301-2701

Irving, TX  
Tel: 972-871-1206 • Fax: 972-641-8946  
Toll Free: 1-800-451-4414

### CANADA

Simcoe, Ontario  
Tel: 519-426-4551 • Fax: 519-426-5509

### EUROPE AND MIDDLE EAST

Tel: +31-53-5725570 • Fax: +31-53-5725579  
International Customer Service  
Tel: +1-708-885-3000 • Fax: +1-708-534-5441

### MEXICO, PUERTO RICO AND LATIN AMERICA

International Customer Service  
Tel: +1-708-885-3000 • Fax: +1-708-534-5441

## U.S. REGIONAL DISTRIBUTION CENTERS

**UNIVERSITY PARK**  
750 Central Avenue  
University Park, IL 60484

**IRVING**  
1401 Valley View Lane, Suite 150  
Irving, TX 75061

**COLUMBIA**  
800 Malleable Road  
Columbia, PA 17512

**ONTARIO**  
1470 S. Vintage Avenue  
Ontario, CA 91761

## ANVIL EPS

Engineered Pipe Supports  
Customer Service Center  
160 Frenchtown Road  
North Kingstown, RI 02852  
Tel: 401-886-3000  
Fax: 401-886-3010  
Toll Free: 1-877-406-3108

## additional INVENTORY LOCATIONS\*

**UNITED STATES:** Arizona, Colorado, Georgia, Indiana, Massachusetts, Minnesota, Missouri, New York, Tennessee, Texas, Washington and Wisconsin

**INTERNATIONAL:** Ontario, Canada and Waalwijk, Netherlands

\*Inventory varies at locations

#617 / Printed in USA / ©2012  
Revision: June 21, 2012

BUILDING CONNECTIONS THAT LAST



www.anvilintl.com