



## **GRUVLOK® CTS COPPER SYSTEM**

Price Sheet GR.CTS-3.11 | Effective Date: March 7, 2011 | Cancels Price Sheet CTS-5.10 of May 10, 2010

**FOR THE MOST CURRENT PRODUCT/PRICING INFORMATION ON ANVIL PRODUCTS,  
PLEASE VISIT OUR WEBSITE AT [WWW.ANVILINTL.COM](http://WWW.ANVILINTL.COM)**

### **FREIGHT ALLOWANCE:**

All prices are F.O.B. point of shipment. On shipments weighing 2,500 pounds or more, rail freight or motor freight at the lowest published rate is allowed to all continental U.S. rail points or all U.S. highway points listed in published tariffs (Alaska and Hawaii excluded). In no case will more than actual freight be allowed.

### **NOTE:**

All orders are accepted on the basis of prices in effect at the time of shipment.

### **NOTICE:**

To the prices and terms quoted, there will be added any manufacturers or sales tax payable on the transaction under any effective statute.

### **GENERAL:**

- UPC numbers and SPIN commodity identification numbers are available upon request.
- To obtain current ISO certifications, listings and other approvals, visit Anvil's Web site at [www.anvilintl.com](http://www.anvilintl.com).
- Pricing is subject to change without notice. Go to Anvil's Web site for the most current list price information, or contact your local Anvil representative.

### **LOSS OR DAMAGE CLAIMS:**

All goods are shipped at buyer's risk. Shipments should be carefully examined upon delivery and before the carrier's delivery receipt is signed. If any loss or damage is evident, the buyer should make an appropriate notation on the delivery receipt and insist that the carrier's driver initial such exception. The contents of all packages should be carefully examined for concealed damage as soon as possible after delivery, so that the carrier can be requested, within 48 hours after delivery, to arrange for prompt inspection of the damaged goods.

**NORTHERN REGION  
CUSTOMER SERVICE CENTER  
800-301-2701**

**SOUTHERN REGION  
CUSTOMER SERVICE CENTER  
800-451-4414**

[www.anvilintl.com](http://www.anvilintl.com)

## 1. CONTROLLING PROVISIONS:

These terms and conditions shall control with respect to any purchase order or sale of Seller's products. No waiver, alteration or modification of these terms and conditions, whether on Buyer's purchase order or otherwise, shall be valid unless the waiver, alteration or modification is specifically accepted in writing and signed by an authorized representative of Seller.

## 2. DELIVERY:

Seller will make every effort to complete delivery of products as indicated on Seller's acceptance of an order, but Seller assumes no responsibility or liability, and will accept no backcharge, for loss or damage due to delay or inability to deliver caused by acts of God, war, labor difficulties, accident, delays of carriers, by contractors or suppliers, inability to obtain materials, shortages of fuel and energy, or any other causes of any kind whatever beyond the control of Seller. Seller may terminate any contract of sale of its products without liability of any nature, by written notice to Buyer, in the event that the delay in delivery or performance resulting from any of the aforesaid causes shall continue for a period of sixty (60) days. Under no circumstances shall Seller be liable for any special or consequential damages or for loss, damage or expense (whether or not based on negligence) directly or indirectly arising from delays or failure to give notice of delay.

## 3. WARRANTY:

Seller warrants for one year from the date of shipment Seller's manufactured products to the extent that Seller will replace those having defects in material or workmanship when used for the purpose and in the manner which Seller recommends. If Seller examination shall disclose to its satisfaction that the products are defective, and an adjustment is required, the amount of such adjustment shall not exceed the net sales price of the defective products only and no allowance will be made for labor or expense of repairing or replacing defective products or workmanship of damage resulting from the same. Seller warrants the products which it sells of other manufacturers to the extent of the warranties of their respective makers. Where engineering design or fabrication work is supplied. Buyer's acceptance of Seller's design or of delivery of work shall relieve Seller of all further obligation, other than expressed in Seller's product warranty. THIS IS SELLER'S SOLE WARRANTY. SELLER MAKES NO OTHER WARRANTY OF ANY KIND, EXPRESSED OR IMPLIED, AND ALL IMPLIED WARRANTIES OF MERCHANTABILITY AND FOR A PARTICULAR PURPOSE WHICH EXCEED SELLER'S AFORESTATED OBLIGATION ARE HEREBY DISCLAIMED BY SELLER AND EXCLUDED FROM THIS WARRANTY. Seller neither assumes, nor authorizes any person to assume for it, any other obligation in connection with the sale of its engineering designs or products. This warranty shall not apply to any products or parts of products which (a) have been repaired or altered outside of Seller's factory, in any manner; (b) have been subjected to misuse, negligence or accidents; (c) have been used in a manner contrary to Seller's instructions or recommendations. Seller shall not be responsible for design errors due to inaccurate or incomplete information supplied by Buyer or its representatives.

## 4. SELLER'S LIABILITY:

Seller will not be liable for any loss, damage, cost of repairs, incidental or consequential damages of any kind, whether based upon warranty (except for the obligation accepted by Seller under "Warranty" above), contract or negligence, arising in connection with the design, manufacture, sale, use or repair of the products or of the engineering designs supplied to Buyer.

## 5. RETURNS:

Seller cannot accept return of any products unless its written permission has been first obtained, in which case same will be credited subject to the following (a) All material returned must, on its arrival at Seller's Plant, be found to be in first-class condition; if not, cost of putting in saleable condition will be deducted from credit memoranda; (b) A handling charge deduction of twenty percent (20%) will be made from all credit memoranda issued for material returned; (c) Transportation charges, if not prepaid, will be deducted from credit memoranda.

## 6. SHIPMENTS:

All products sent out will be carefully examined, counted and packed. The cost of any special packing or special handling caused by Buyer's requirements or requests shall be added to the amount of the order. No claim for shortages will be allowed unless made in writing within ten (10) days of receipt of a shipment.

Claims for products damaged or lost in transit should be made on the carrier, as Seller's responsibility ceases, and title passes, on delivery to the carrier.

## 7. SPECIAL PRODUCTS:

Orders covering special or nonstandard products are not subject to cancellation except on such terms as Seller may specify on application.

## 8. PRICES AND DESIGNS:

Prices and designs are subject to change without notice. All prices are F.O.B. point of shipment, unless otherwise stated.

## 9. TAXES:

The amount of any sales, excise or other taxes, if any, applicable to the products covered by this order, shall be paid by Buyer unless Buyer provides Seller with an exemption certificate acceptance to the taxing authorities.

## 10. NUCLEAR PLANTS:

Where the products, engineering design or fabrication is for nuclear plant applications. Buyer agrees (a) to take all necessary steps to add Seller as an insured under the American Nuclear Insurers' (ANI) pool and under the Mutual Atomic Energy Reinsurance Pool (MAERP) for property damage and liability insurance, and if necessary steps could have been taken, but are not taken, Buyer shall hold Seller harmless against all such losses which could have been thus covered; (b) Buyer agrees to hold Seller harmless with respect to any personal injury (or death), property damage or other loss in a nuclear incident which is caused directly or indirectly by defective design, material, workmanship furnished by Buyer (or which could be so covered but with respect to which Buyer has elected to self-insure) and further agrees to waive subrogation by its carriers of such insurance against Seller, and (c) as to nuclear hazards for which Buyer cannot obtain insurance coverage, the liability of Seller for any personal injury (or death), property damage or other loss directly caused by defective design, material or workmanship furnished by Seller shall not exceed the value at the time of the loss occurrence.

## 11. MINIMUM INVOICE:

Domestic: \$100 plus transportation.  
International: \$500 plus transportation.

## 12. TERMS:

Cash, net 30 days unless otherwise specified.

NOTICE: All orders are accepted on the basis of prices in effect at the time of shipment.

NOTICE: To the prices and terms quoted, there will be added any manufacturers or sales tax payable on the transaction under any effective statute.

FREIGHT ALLOWANCE: All prices are F.O.B. point of shipment. On shipments weighing 2,500 pounds or more, rail freight or motor freight at the lowest published rate is allowed to all continental U.S. rail points or all U.S. highway points listed in published tariffs (Alaska and Hawaii excluded). In no case will more than actual freight be allowed. Shipments (weighing less than 2,500 pounds) will be shipped prepaid. The buyer will be invoiced for freight costs at the applicable published class, exception or commodity rate(s) or charge(s). Anvil reserves the right to select the carrier for all shipments.



Contact an ANVIL representative for details related to these listings.

**Rigid Coupling Fig. 6400**

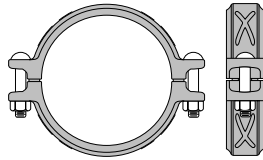

NOMINAL PIPE SIZE (INCHES)	PIPE OUTSIDE DIAMETER (INCHES)	APRX. WEIGHT EACH (LBS.)	COUPLING COMPLETE WITH "E" FLUSH GAP GASKET (PRICE EACH) PAINTED*	BOX QTY.	PLATED BOLT AND NUT SIZE (INCHES)
2	2.125	1.53	\$40.00	42	3/8 x 2 1/4
2 1/2	2.625	1.78	\$43.75	30	3/8 x 2 1/4
3	3.125	2.76	\$48.50	20	1/2 x 3
4	4.125	3.27	\$74.00	17	1/2 x 3
5	5.125	4.71	\$125.25	10	5/8 x 3 1/2
6	6.125	5.24	\$165.75	8	5/8 x 3 1/2
8	8.125	7.67	\$257.25	5	5/8 x 3 1/2

\*Gasket Color: Copper

**Flange Adapter Fig. 6084**

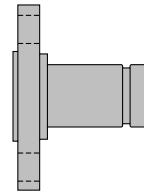

NOMINAL PIPE SIZE HINGED (INCHES)	PIPE OUTSIDE DIAMETER (INCHES)	APRX. WEIGHT EACH (LBS.)	FLANGE (PRICE EACH) PAINTED	BOX QTY.
2	2.125	4.60	\$311.00	10
2 1/2	2.625	6.20	\$323.50	6
3	3.125	6.60	\$339.00	5
4	4.125	9.30	\$372.00	3
5	5.125	10.20	\$500.50	3
6	6.125	12.00	\$544.50	2

**90° Elbow Fig. 6050 (Gr x Gr)**

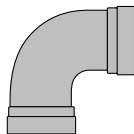

NOMINAL PIPE SIZE (INCHES)	PIPE OUTSIDE DIAMETER (INCHES)	APRX. WEIGHT EACH (LBS.)	PRICE EACH	BOX QTY.
2	2.125	0.75	\$71.00	35
2 1/2	2.625	1.15	\$77.00	20
3	3.125	1.88	\$108.50	12
4	4.125	4.07	\$250.50	4
5	5.125	6.94	\$712.50	2
6	6.125	11.12	\$1,137.00	1
8	8.125	21.81	\$2,136.00	1

**45° Elbow Fig. 6051 (Gr x Gr)**

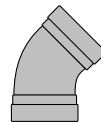

NOMINAL PIPE SIZE (INCHES)	PIPE OUTSIDE DIAMETER (INCHES)	APRX. WEIGHT EACH (LBS.)	PRICE EACH	BOX QTY.
2	2.125	0.61	\$71.00	44
2 1/2	2.625	0.89	\$77.00	25
3	3.125	1.38	\$108.50	15
4	4.125	2.99	\$250.50	5
5	5.125	4.00	\$712.50	4
6	6.125	6.16	\$1,137.00	2
8	8.125	13.66	\$2,136.00	2

**Tee Fig. 6060 (Gr x Gr x Gr)**

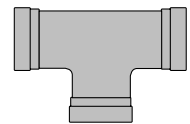

NOMINAL PIPE SIZE (INCHES)	PIPE OUTSIDE DIAMETER (INCHES)	APRX. WEIGHT EACH (LBS.)	PRICE EACH	BOX QTY.
2	2.125	1.45	\$117.50	25
2 1/2	2.625	2.37	\$125.00	14
3	3.125	3.38	\$186.00	8
4	4.125	5.77	\$409.00	4
5	5.125	12.84	\$1,147.50	2
6	6.125	21.00	\$1,418.00	1
8	8.125	21.81	\$2,533.00	1



Certified to ANSINSP #1

Contact an ANVIL representative for details related to these listings.

**Copper Reducing Tee Fig. 6061**  
(Gr x Gr x Gr)

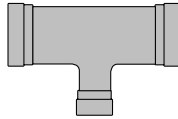

NOMINAL PIPE SIZE (INCHES)		APRX. WEIGHT EACH (LBS.)	PRICE EACH	BOX QTY.
2½ x 2½	x 2	2.54	\$186.50	14
3 x 3	x 2	2.90	\$240.00	12
	x 2½	3.16	\$317.00	10
4 x 4	x 2	5.14	\$538.00	5
	x 2½	5.36	\$538.00	5
5 x 5	x 3	5.88	\$538.00	5
	x 4	7.45	\$1,644.50	3
6 x 6	x 4	8.13	\$1,644.50	2
	x 2½	9.42	\$2,008.50	2
	x 3	10.06	\$2,008.50	2
	x 5	10.86	\$2,008.50	2
	x 5	12.73	\$2,008.50	2

**Copper Reducing Tee Fig. 6064**  
(Gr x Gr x Cup)

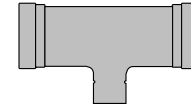

NOMINAL PIPE SIZE (INCHES)		APRX. WEIGHT EACH (LBS.)	PRICE EACH	BOX QTY.
2 x 2	x ¾	0.88	\$150.50	35
	x 1	1.03	\$150.50	35
	x 1¼	1.12	\$150.50	25
2½ x 2½	x 1½	1.25	\$150.50	25
	x ¾	1.25	\$192.00	20
	x 1	1.38	\$187.00	15
3 x 3	x 1¼	1.56	\$187.00	15
	x 1½	1.88	\$187.00	15
	x ¾	1.88	\$346.50	20
4 x 4	x 1	2.04	\$346.50	16
	x 1¼	2.13	\$346.50	15
	x 1½	2.25	\$346.50	12
4 x 4	x ¾	3.63	\$410.00	8
	x 1	3.94	\$538.00	8
	x 1¼	4.24	\$538.00	6
	x 1½	4.47	\$538.00	6

**Concentric Reducer Fig. 6072**  
(Gr x Gr)

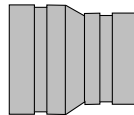

NOMINAL SIZE X BRANCH (INCHES)	OUTLET (INCHES)	END TO END (INCHES)	APRX. WEIGHT EACH (LBS.)	PRICE EACH	BOX QTY.
2½	x 2	3.29	0.58	\$102.50	60
3	x 2	2.50	0.58	\$102.50	77
	x 2½	2.50	0.62	\$102.50	72
4	x 2	4.75	1.71	\$211.00	18
	x 2½	3.00	1.12	\$211.00	30
5	x 3	3.00	1.22	\$211.00	30
	x 4	3.88	2.11	\$595.50	12
6	x 3	3.38	1.97	\$595.50	12
	x 4	4.38	2.96	\$644.50	7
8	x 4	3.88	2.87	\$644.50	8
	x 5	3.38	2.78	\$644.50	8
8	x 6	5.00	6.60	\$1,132.00	4

**Concentric Reducer Fig. 6075**  
(Gr x Cup)

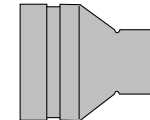

NOMINAL SIZE X BRANCH (INCHES)	OUTLET (INCHES)	END TO END (INCHES)	CUP LENGTH (INCHES)	APRX. WEIGHT EACH (LBS.)	PRICE EACH	BOX QTY.
2	x 1	2.70	0.91	0.32	\$85.00	87
	x 1¼	3.00	0.97	0.36	\$85.00	33
	x 1½	2.94	1.09	0.38	\$85.00	120
2½	x 1	3.25	0.91	0.53	\$104.00	66
	x 1¼	3.52	0.97	0.59	\$104.00	53
	x 1½	3.45	1.09	0.59	\$104.00	66
3	x 2	3.30	1.34	0.58	\$104.00	60
	x 1½	3.68	1.09	0.84	\$129.00	40
4	x 2	4.10	1.34	0.97	\$129.00	40
	x 2	4.75	1.34	1.76	\$241.00	18



Contact an ANVIL representative for details related to these listings.

**Cap Fig. 6074**

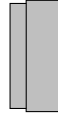

NOMINAL PIPE SIZE (INCHES)	APRX. WEIGHT EACH (LBS.)	PRICE EACH	BOX QTY.
2	0.36	\$49.00	41
2½	0.50	\$72.50	70
3	0.69	\$91.00	55
4	1.15	\$136.50	30
5	1.81	\$154.00	16
6	2.68	\$280.00	10

**Fig. 6700 Series Butterfly Valve**



NOMINAL SIZE (INCHES)	PIPE OUTSIDE DIAMETER (INCHES)	APRX. WEIGHT EACH (LBS.)	PRICE EACH	BOX QTY.
2½	2.625	5.90	\$748.00	5.90
3	3.125	6.60	\$821.50	6.60
4	4.125	11.00	\$1,039.50	11.00
5	5.125	17.60	\$1,322.00	17.60
6	6.125	21.60	\$1,413.00	21.60

- NOTES -

- NOTES -



## Corporate Offices

110 Corporate Drive, Suite 10  
P.O. Box 3180  
Portsmouth, NH 03801-3180  
Tel: 603-422-8000  
Fax: 603-422-8033  
E-mail: [webmaster@anvilintl.com](mailto:webmaster@anvilintl.com)

## U.S. REGIONAL SERVICE CENTERS

### Northern Region

Regional Distribution & Customer Service Center

750 Central Avenue  
University Park, IL 60484  
Tel: 708-885-3000  
Fax: 708-534-5441  
Toll Free: 1-800-301-2701

### Southern Region

Regional Distribution & Customer Service Center

1401 Valley View Lane, Suite 150  
Irving, TX 75061  
Tel: 972-871-1206  
Fax: 972-641-8946  
Toll Free: 1-800-451-4414

## CANADA SERVICE CENTER

### Anvil International Canada Customer Service Center

390 Second Avenue  
P.O. Box 40  
Simcoe, Ontario N3Y 4K9  
Tel: 519-426-4551  
Fax: 519-426-5509

## INTERNATIONAL SALES

### Europe and Middle East Region

Rick van Meesen, *Sales Director*  
The Netherlands  
[rivanmeesen@anvilintl.com](mailto:rivanmeesen@anvilintl.com)  
Tel: +31-53-5725570  
Fax: +31-53-5725579  
International Customer Service  
Tel: +1-708-885-3000  
Fax: +1-708-534-5441

### Mexico, Puerto Rico and Latin America

Abraham Quijada, *Sales Manager*  
[aquijada@anvilintl.com](mailto:aquijada@anvilintl.com)  
Tel: +1-281-590-4600  
International Customer Service  
Tel: +1-708-885-3000  
Fax: +1-708-534-5441

#615 / Printed in USA / ©2011  
Revision: March 7, 2011

BUILDING CONNECTIONS THAT LAST



[www.anvilintl.com](http://www.anvilintl.com)