



Fire Products Division of Anvil International



## FIRE PROTECTION DOMESTIC PRODUCTS

Price Sheet GFPL-3-2008 | Effective March 3, 2008 | Cancels Price Sheet of August 20, 2007

### PRICING

- Pricing is subject to change without notice. Go to Anvil's Web site for the most current list price information, or contact your local Anvil representative.
- All orders are accepted on the basis of prices in effect at the time of shipment.
- To the prices and terms quoted, there will be added any manufacturers or sales tax payable on the transaction under any effective statute.

### SHIPPING

- All prices are F.O.B. point of shipment. Title of goods shall pass to the buyer upon delivery of the shipment to the carrier.
- All goods are shipped at buyer's risk. Shipments should be carefully examined upon delivery and before the carrier's delivery receipt is signed. If any loss or damage is evident, the buyer should make an appropriate notation on the delivery receipt and insist that the carrier's driver initial such exception. The contents of all packages should be carefully examined for concealed damage as soon as possible after delivery, so that the carrier can be requested, within 48 hours after delivery, to arrange for prompt inspection of the damaged goods.
- Anvil reserves the right to select the carrier for all shipments.

### GENERAL

- UPC numbers are available upon request.
- To obtain current ISO certifications, listings, and other approvals, visit Anvil's Web site at [www.anvilstar.com](http://www.anvilstar.com).

**EASTERN REGION**  
800-451-2935

**NORTHERN REGION**  
800-301-2701

**SOUTHERN REGION**  
800-451-4414

**WESTERN REGION**  
800-572-0051

## 1. CONTROLLING PROVISIONS:

These terms and conditions shall control with respect to any purchase order or sale of Seller's products. No waiver, alteration or modification of these terms and conditions whether on Buyer's purchase order or otherwise shall be valid unless the waiver, alteration or modification is specifically accepted in writing and signed by an authorized representative of Seller.

## 2. DELIVERY:

Seller will make every effort to complete delivery of products as indicated on Seller's acceptance of an order, but Seller assumes no responsibility or liability, and will accept no backcharge, for loss or damage due to delay or inability to deliver caused by acts of God, war, labor difficulties, accident, delays of carriers, by contractors or suppliers, inability to obtain materials, shortages of fuel and energy, or any other causes of any kind whatever beyond the control of Seller. Seller may terminate any contract of sale of its products without liability of any nature, by written notice to Buyer, in the event that the delay in delivery or performance resulting from any of the aforesaid causes shall continue for a period of sixty (60) days. Under no circumstances shall Seller be liable for any special or consequential damages or for loss, damage, or expense (whether or not based on negligence) directly or indirectly arising from delays or failure to give notice of delay.

## 3. WARRANTY:

Seller warrants for one year from the date of shipment Seller's manufactured products to the extent that Seller will replace those having defects in material or workmanship when used for the purpose and in the manner which Seller recommends. If Seller examination shall disclose to its satisfaction that the products are defective, and an adjustment is required, the amount of such adjustment shall not exceed the net sales price of the defective products only and no allowance will be made for labor or expense of repairing or replacing defective products or workmanship of damage resulting from the same. Seller warrants the products which it sells of other manufacturers to the extent of the warranties of their respective makers. Where engineering design or fabrication work is supplied. Buyer's acceptance of Seller's design or of delivery of work shall relieve Seller of all further obligation, other than expressed in Seller's product warranty. THIS IS SELLER'S SOLE WARRANTY. SELLER MAKES NO OTHER WARRANTY OF ANY KIND, EXPRESSED OR IMPLIED AND ALL IMPLIED WARRANTIES OF MERCHANTABILITY AND FOR A PARTICULAR PURPOSE WHICH EXCEED SELLER'S AFORESTATED OBLIGATION ARE HEREBY DISCLAIMED BY SELLER AND EXCLUDED FROM THIS WARRANTY. Seller neither assumes, nor authorizes any person to assume for it, any other obligation in connection with the sale of its engineering designs or products. This warranty shall not apply to any products or parts of products which (a) have been repaired or altered outside of Seller's factory, in any manner; (b) have been subjected to misuse, negligence or accidents; (c) have been used in a manner contrary to Seller's instructions or recommendations. Seller shall not be responsible for design errors due to inaccurate or incomplete information supplied by Buyer or its representatives.

## 4. SELLER'S LIABILITY:

Seller will not be liable for any loss, damage, cost of repairs, incidental or consequential damages of any kind, whether based upon warranty (except for the obligation accepted by Seller under "Warranty" above), contract or negligence, arising in connection with the design, manufacture, sale, use or repair of the products or of the engineering designs supplied to Buyer.

## 5. RETURNS:

Seller cannot accept return of any products unless its written permission has been first obtained, in which case same will be credited subject to the following (a) All material returned must, on its arrival at Seller's Plant, be found to be in first-class condition; if not, cost of putting in saleable condition will be deducted from credit memoranda; (b) A handling charge deduction of twenty percent (20%) will be made from all credit memoranda issued for material returned; (c) Transportation charges, if not prepaid will be deducted from credit memoranda.

## 6. SHIPMENTS:

All products sent out will be carefully examined, counted and packed. The cost of any special packing or special handling caused by Buyer's requirements or requests shall be added to the amount of the order. No claim for shortages will be allowed unless made in writing within ten (10) days of receipt of a shipment.

Claims for products damaged or lost in transit should be made on the carrier, as Seller's responsibility ceases, and title passes, on delivery to the carrier.

## 7. SPECIAL PRODUCTS:

Orders covering special or nonstandard products are not subject to cancellation except on such terms as Seller may specify on application.

## 8. PRICES AND DESIGNS:

Prices and designs are subject to change without notice. All prices are F.O.B. Point of shipment, unless otherwise stated.

## 9. TAXES:

The amount of any sales, excise or other taxes, if any, applicable to the products covered by this order, shall be paid by Buyer unless Buyer provides Seller with an exemption certificate acceptance to the taxing authorities.

## 10. NUCLEAR PLANTS:

Where the products, engineering design or fabrication is for nuclear plant applications. Buyer agrees (a) to take all necessary steps to add Seller as an insured under the American Nuclear Insurers' (ANI) pool and under the Mutual Atomic Energy Reinsurance Pool (MAERP) for property damage and liability insurance and if necessary steps could have been taken, but are not taken, Buyer shall hold Seller harmless against all such losses which could have been thus covered (b) Buyer agrees to hold Seller harmless with respect to any personal injury (or death), property damage or other loss in a nuclear incident which is caused directly or indirectly by defective design, material, workmanship furnished by Seller (or which could be so covered but with respect to which Buyer has elected to self-insure), and further agrees to waive subrogation by its carriers of such insurance against Seller, and (c) as to nuclear hazards for which Buyer cannot obtain insurance coverage, the liability of Seller for any personal injury (or death), property damage or other loss directly caused by defective design, material, or workmanship furnished by Seller shall not exceed the value at the time of the loss occurrence.

## 11. MINIMUM INVOICE:

Domestic: \$100 plus transportation.  
International: \$500 plus transportation.

## 12. TERMS:

Cash, net 30 days unless otherwise specified.

NOTE: All orders are accepted on the basis of prices in effect at the time of shipment.

NOTICE: The prices and terms quoted, there will be added any manufacturers or sales tax payable on the transaction under any effective statute.

FREIGHT ALLOWANCE: All prices are F.O.B. point of shipment. On shipments weighing 2,500 pounds or more, rail freight or motor freight at the lowest published rate, is allowed to all continental U.S. rail points or all U.S. highway points listed in published tariffs (Alaska and Hawaii excluded). In no case will more than actual freight be allowed. Shipments (weighing less than 2,500 pounds) will be shipped prepaid. The buyer will be invoiced for freight costs at the applicable published class, exception or commodity rate(s) or charge(s). Anvil reserves the right to select the carrier for all shipments.

## Table of Contents

<b>Terms and Conditions</b> .....	<b>2</b>
<b>Domestic Fire Protection Components</b> .....	<b>4 – 11</b>
Lightweight Flexible Coupling Fig. 7000 .....	4
Reducing Coupling Fig. 7010 .....	4
Gruvlok Flange Fig. 7012 .....	4
Rigidlite® Coupling Fig. 7400 .....	5
Standard 90° Elbows Fig. 7050S .....	5
90° Drain Elbows Fig. 7050DR .....	5
Standard 45° Elbows Fig. 7051 .....	5
Standard Tees Fig. 7060S .....	6
Bullhead Tee Fig. 7062 .....	6
Standpipe Tee Fig. 7065 .....	6
Cap Fig. 7074 .....	6
Fire-Rite Tees Fig. 7460 Short Pattern Fitting .....	6
Fire-Rite 90° Elbows Fig. 7450 Short Pattern Fitting .....	6
Concentric Reducer Fig. 7072 .....	7
Concentric Reducer Fig. 7076 .....	7
Mechanical Clamp-T® Grooved Outlet Fig. 7046 .....	8
Mechanical Clamp-T® Female Threaded Outlet Fig. 7045 .....	8
Mechanical Clamp-T® Cross, Fig. 7047, Fig. 7048 & Fig. 7049 .....	9
Steel Cross Fig. 7068 .....	10
End of the Line Fitting (EOL) Fig. 7091 .....	10
UL/FM Butterfly Valves Fig. AE7722-3A .....	10
UL/FM Fire Check Valve 78FP .....	10
<b>Sock-It® Fittings</b> .....	<b>11</b>
7100 .....	11
7101 .....	11
7103 .....	11
7105 .....	11
7106 .....	11
7107 .....	11
<b>Spare Parts</b> .....	<b>12</b>
Fig. 7000 Spare Parts, Gaskets .....	12
Fig. 7400 Spare Parts, Gaskets .....	12
Fig. 7010 Spare Parts, Grade E Gaskets .....	12
Sock-It® Fittings Spare Parts, Gaskets and Bolts .....	12
<b>Gasket Selection Guide</b> .....	<b>12</b>
<b>Lubricants</b> .....	<b>12</b>
<b>Cross Reference</b> .....	<b>13</b>

**Note: Price List intended for Fire Protection Products. Other Gruvlok Products may be found in GL-8-2007 and SS "A"-3-2007.**

**Lightweight Flexible Coupling Fig. 7000<sup>†</sup> (with DRI-SEAL™ Grade E Type A Gasket)**

†When ordering, refer to product as FP7000.

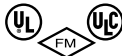
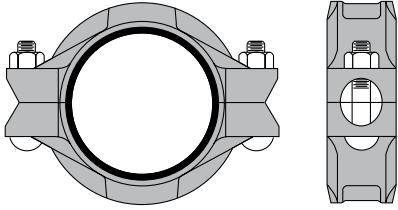

For listing/approval details contact your AnvilStar Representative.

NOMINAL PIPE SIZE (INCHES)	PIPE OUTSIDE DIAMETER (INCHES)	APRX. WEIGHT EACH (LBS)	COUPLING COMPLETE WITH DRI-SEAL™ GASKET		COUPLING COMPLETE WITH FLUSH GAP™ GASKET (TYPE A)	
			PAINTED	GALVANIZED	PAINTED	GALVANIZED
1¼	1.660	1.40	\$24.59	\$31.70	\$40.29	\$48.59
1½	1.900	1.50	\$29.92	\$37.63	\$44.73	\$53.33
2	2.375	1.70	\$30.52	\$38.52	\$45.92	\$54.51
2½	2.875	1.90	\$35.26	\$44.73	\$54.51	\$64.89
3	3.500	2.90	\$40.89	\$51.85	\$58.07	\$70.21
4	4.500	4.60	\$57.48	\$75.25	\$83.25	\$101.91
5	5.563	6.10	\$82.95	\$106.07	\$142.80	\$170.94
6	6.625	8.10	\$99.54	\$129.76	\$157.91	\$191.39
8	8.625	14.20	\$156.14	\$208.57	\$203.83	\$258.93

All bolts are oval-neck track head design to ASTM A-183, with heavy hex nuts to ASTM A-563, and are zinc plated to ASTM B-633. Two bolts per coupling. Spare parts available on page 12.

**Reducing Coupling Fig. 7010<sup>†</sup> (Coupling Complete "E" Gasket)**

†When ordering, refer to product as FP7010.



For listing/approval details contact your AnvilStar Representative.

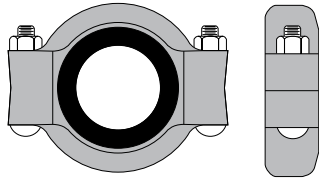

NOMINAL PIPE SIZE (INCHES)	APRX. WEIGHT EACH (LBS)	PRICE EACH	
		PAINTED	GALVANIZED
2 x 1½	3.20	\$50.95	\$61.92
2½ x 2	3.50	\$66.66	\$83.84
3 x 2	4.40	\$76.14	\$96.58
3 x 2½	4.10	\$65.47	\$83.84
4 x 2	8.90	\$120.87	\$153.17
4 x 2½	7.90	\$108.43	\$143.10
4 x 3	6.70	\$101.33	\$131.53
5 x 4	11.40	\$136.88	\$180.41
6 x 4	13.40	\$206.80	\$261.00
6 x 5	13.50	\$181.02	\$234.93
8 x 6	17.70	\$309.90	\$393.14

All bolts are oval-neck track head design to ASTM A-183, with heavy hex nuts to ASTM A-563, and are zinc plated to ASTM B-633. Spare parts available on page 12.

**Gruvlok Flange Fig. 7012<sup>†</sup> (Coupling Complete "E" Gasket)**

†When ordering, refer to product as FP7012.



For listing/approval details contact your AnvilStar Representative.

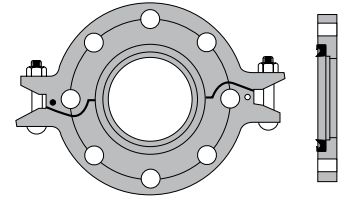

NOMINAL PIPE SIZE (INCHES)	PIPE OUTSIDE DIAMETER (INCHES)	APRX. WEIGHT EACH (LBS)	PRICE EACH	
			PAINTED	GALVANIZED
2*	2.375	3.10	\$109.03	\$126.80
2½	2.875	4.80	\$127.69	\$151.98
3*	3.500	5.30	\$144.28	\$191.20
4*	4.500	7.40	\$187.83	\$253.03
5	5.563	8.60	\$226.64	\$275.53
6*	6.625	9.90	\$246.20	\$300.11
8*	8.625	16.20	\$309.90	\$388.10

The Gruvlok Flange bolt hole pattern conforms to ANSI Class 150 and Class 125 flanges. Gruvlok Flange adapter insert required when mating to rubber surfaces or serrated faced mating flanges. Refer to Gruvlok Products Catalog or Anvil's Web site for more information on installing this flange. Mating flange bolts must be at least intermediate strength bolting per ASME B16.5. Bolts with material properties equal to or greater than SAE J429 Grade 5 are acceptable.

**Rigidlite® Coupling Fig. 7400<sup>†</sup> (with DRI-SEAL™ Grade E Type A Gasket)**

†When ordering, refer to product as FP7400.

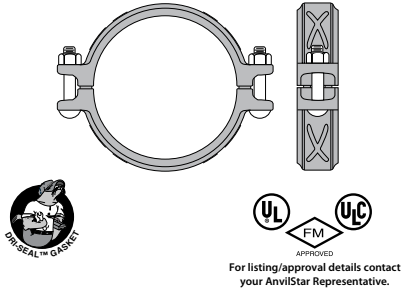

NOMINAL PIPE SIZE (INCHES)	PIPE OUTSIDE DIAMETER (INCHES)	APRX. WEIGHT EACH (LBS)	COUPLING COMPLETE WITH DRI-SEAL™ GASKET		COUPLING COMPLETE WITH FLUSH GAP™ GASKET (TYPE A)	
			PAINTED	GALVANIZED	PAINTED	GALVANIZED
1¼	1.660	1.30	\$22.52	\$27.26	\$34.66	\$39.11
1½	1.900	1.40	\$23.11	\$28.14	\$37.03	\$42.95
2	2.375	1.60	\$26.07	\$31.41	\$39.70	\$46.21
2½	2.875	1.90	\$30.23	\$36.44	\$47.11	\$54.81
3	3.500	2.10	\$34.96	\$42.66	\$50.95	\$59.54
4	4.500	3.10	\$49.47	\$59.54	\$72.28	\$84.13
5	5.563	4.60	\$70.80	\$89.48	\$122.35	\$141.62
6	6.625	5.50	\$85.32	\$103.69	\$135.69	\$158.21
8	8.625	8.40	\$143.10	\$174.20	\$220.13	\$255.38

All bolts are oval-neck track head design to ASTM A-183, with heavy hex nuts to ASTM A-563, and are zinc plated to ASTM B-633. Two bolts per coupling. Spare parts available on page 12.

**Standard Dimension Fittings**

**Standard 90° Elbows Fig. 7050S<sup>†</sup> for Fire Protection**

†When ordering, refer to product as FP7050S.

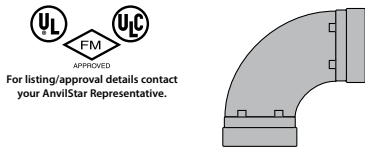

NOMINAL PIPE SIZE (INCHES)	APRX. WEIGHT EACH (LBS)	PRICE EACH	
		PAINTED	GALVANIZED
1¼	1.00	\$23.64	\$30.23
1½	1.20	\$23.64	\$30.23
2	1.70	\$23.64	\$30.23
2½	2.60	\$31.64	\$43.03
3	4.00	\$40.11	\$56.22
4	7.70	\$59.91	\$85.27
5	11.10	\$147.78	\$194.05
6	16.50	\$173.37	\$238.84
8	30.60	\$341.29	\$484.80

**90° Drain Elbows Fig. 7050DR**



NOMINAL PIPE SIZE (INCHES)	APRX. WEIGHT EACH (LBS)	PRICE EACH	
		PAINTED	GALVANIZED
2	2.76	\$50.21	POA
2½	4.33	\$103.39	\$133.33
3	5.60	\$132.14	\$158.50
4	8.80	\$134.79	\$183.38
6	18.77	\$237.30	\$338.03
8	32.64	\$146.42	POA

**Standard 45° Elbows Fig. 7051<sup>†</sup> for Fire Protection**

†When ordering, refer to product as FP7051.

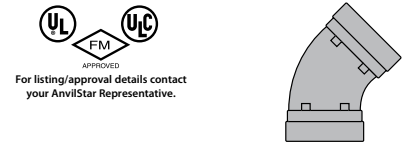

NOMINAL PIPE SIZE (INCHES)	APRX. WEIGHT EACH (LBS)	PRICE EACH	
		PAINTED	GALVANIZED
1¼	0.70	\$23.64	\$30.23
1½	0.90	\$23.64	\$30.23
2	1.50	\$23.64	\$30.23
2½	1.90	\$31.64	\$43.03
3	3.30	\$40.11	\$56.22
4	5.40	\$59.91	\$85.27
5	9.00	\$147.78	\$194.05
6	11.20	\$173.37	\$238.84
8	19.80	\$341.29	\$484.80

**Standard Tees Fig. 7060S<sup>†</sup>**  
**for Fire Protection Fitting**

<sup>†</sup>When ordering, refer to product as FP7060S.

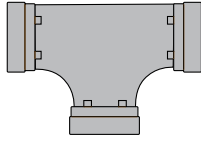

NOMINAL PIPE SIZE (INCHES)	APRX. WEIGHT EACH (LBS)	PRICE EACH	
		PAINTED	GALVANIZED
1¼	1.50	\$36.20	\$48.54
1½	1.80	\$36.20	\$48.54
2	2.40	\$36.20	\$48.54
2½	4.00	\$48.64	\$66.72
3	5.80	\$68.20	\$94.09
4	10.30	\$104.23	\$145.11
5	16.20	\$244.11	\$326.06
6	25.70	\$282.04	\$392.43
8	41.10	\$600.87	\$846.17

**Bullhead Tees Fig. 7062**  
**for Fire Protection Fitting**

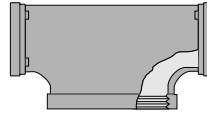

NOMINAL PIPE SIZE (INCHES)	APRX. WEIGHT EACH (LBS)	PRICE EACH	
		PAINTED	GALVANIZED
5 x 5 x 8	31.00	\$1,094.39	\$1,379.38
6 x 6 x 8	37.60	\$1,251.40	\$1,547.36

\*Fabricated steel.  
Additional sizes quoted on application.

**Standpipe Tees Fig. 7065**

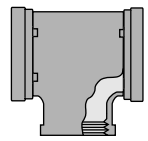

NOMINAL PIPE SIZE (INCHES)	APRX. WEIGHT EACH (LBS)	PRICE EACH	
		PAINTED	GALVANIZED
4 x 4 x 2½	7.60	\$202.64	\$258.34
6 x 6 x 2½	11.20	\$302.48	\$376.84

\*Fabricated steel.  
Additional sizes quoted on application.

**Cap Fig. 7074<sup>†</sup>**

<sup>†</sup>When ordering, refer to product as FP7074.

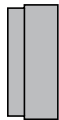

NOMINAL PIPE SIZE (INCHES)	APRX. WEIGHT EACH (LBS)	PRICE EACH	
		PAINTED	GALVANIZED
1	-	POA	POA
1¼	0.50	\$11.56	\$18.07
1½	0.50	\$12.14	\$18.37
2	0.50	\$14.22	\$20.43
2½	0.70	\$16.88	\$23.11
3	1.10	\$20.75	\$27.26
4	2.80	\$31.70	\$43.56
5	4.00	\$65.18	\$89.48
6	6.00	\$73.18	\$101.62
8	12.50	\$139.84	\$192.27

**Fire-Rite Tees Fig. 7460<sup>†</sup>**  
**Short Pattern Fitting**

<sup>†</sup>When ordering, refer to product as FP7460.

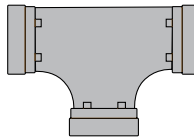

NOMINAL PIPE SIZE (INCHES)	APRX. WEIGHT EACH (LBS)	PRICE EACH	
		PAINTED	GALVANIZED
2	2.48	\$34.96	\$43.85
2½	3.53	\$46.82	\$59.85
3	4.80	\$65.18	\$84.43
4	8.12	\$99.25	\$130.65
6	19.10	\$268.11	\$349.88
8	35.20	\$570.89	\$754.57

**Fire-Rite 90° Elbows**  
**Fig. 7450<sup>†</sup> Short Pattern Fitting**  
**for Fire Protection**

<sup>†</sup>When ordering, refer to product as FP7450.

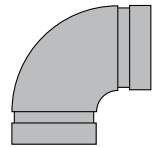

NOMINAL PIPE SIZE (INCHES)	APRX. WEIGHT EACH (LBS)	PRICE EACH	
		PAINTED	GALVANIZED
2	1.71	\$22.81	\$29.33
2½	2.60	\$30.52	\$41.47
3	3.46	\$40.29	\$54.22
4	6.50	\$58.96	\$81.77
6	14.82	\$165.01	\$228.13
8	25.66	\$324.40	\$462.76

**Concentric Reducer Fig. 7072,  
Groove by Groove (Gr x Gr)**



For listing/approval details contact your AnvilStar Representative.

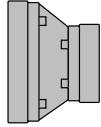

(Cast)



(Weld)

NOMINAL PIPE SIZE RUN (INCHES)	OUTLET (INCHES)	APRX. WEIGHT EACH (LBS)	PRICE EACH	
			PAINTED	GALVANIZED
1 1/4	x1*	0.60	\$209.46	\$231.08
1 1/2	x1*	0.60	\$51.25	\$60.15
	x 1 1/4*	0.60	\$51.25	\$60.15
2	x1*	0.80	\$51.25	\$60.15
	x 1 1/4	1.30	\$56.29	\$66.06
	x 1 1/2	1.30	\$51.25	\$60.15
2 1/2	x1*	1.00	\$322.93	\$355.21
	x 1 1/4*	1.00	\$51.25	\$60.15
	x 1 1/2*	1.30	\$51.25	\$60.15
	x2	1.60	\$51.25	\$60.15
3	x1*	1.20	\$56.29	\$68.44
	x 1 1/4*	1.30	\$321.14	\$360.24
	x 1 1/2*	1.30	\$61.62	\$75.55
	x2	1.40	\$45.04	\$55.11
	x2 1/2*	1.60	\$61.62	\$74.66
3 1/2	x3*	1.50	\$65.77	\$79.10
	x1	2.20	\$67.54	\$83.84
4	x 1 1/4*	2.20	\$530.60	\$594.30
	x 1 1/2*	2.30	\$405.87	\$444.10
	x2	2.40	\$59.85	\$74.07
	x2 1/2	2.60	\$74.66	\$91.25
	x3	3.20	\$74.66	\$91.25
	x3 1/2	3.60	\$74.66	\$91.25
5	x2	4.60	\$746.57	\$824.79
	x2 1/2*	4.50	\$579.48	\$628.67
	x3*	4.40	\$87.10	\$107.55
	x4	4.50	\$103.99	\$130.36
	x1*	6.80	\$138.06	\$172.12
6	x 1 1/4*	6.90	\$795.63	\$942.16
	x 2	6.00	\$138.06	\$172.12
	x2 1/2*	6.00	\$153.76	\$189.02
	x3	5.40	\$138.06	\$172.12
	x4	5.60	\$119.98	\$156.14
	x5	6.00	\$177.76	\$221.90
8	x3*	12.00	\$246.20	\$307.52
	x4	9.00	\$246.20	\$309.00
	x5*	11.50	\$246.20	\$311.07
	x6	10.60	\$313.74	\$393.14

**Concentric Reducer Fig. 7076,  
Groove by Thread (Gr x Thd)**



For listing/approval details contact your AnvilStar Representative.

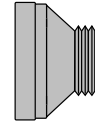

(Weld)

NOMINAL PIPE SIZE RUN (INCHES)	OUTLET (INCHES)	APRX. WEIGHT EACH (LBS)	PRICE EACH	
			PAINTED	GALVANIZED
1 1/2	x1*	0.60	\$53.03	\$65.77
2	x 3/4*	1.00	\$53.03	\$65.77
	x 1	0.80	\$53.03	\$65.77
	x 1 1/4	1.30	\$53.03	\$65.77
2 1/2	x 1 1/2	1.30	\$53.03	\$65.77
	x1	1.00	\$311.67	\$332.40
	x 1 1/4*	1.00	\$75.84	\$93.91
	x 1 1/2*	1.30	\$79.40	\$93.91
3	x2	1.20	\$53.03	\$65.77
	x 3/4*	1.20	\$389.88	\$415.65
	x1*	1.20	\$58.07	\$69.92
	x 1 1/4	1.30	\$62.64	\$67.33
	x 1 1/2*	1.30	\$65.77	\$78.81
	x2*	1.30	\$65.77	\$78.81
4	x2 1/2	1.50	\$79.40	\$93.91
	x 1*	2.20	\$75.25	\$91.25
	x 1 1/4	2.20	\$382.91	\$392.69
	x 1 1/2*	2.30	\$424.54	\$458.02
	x2*	2.40	\$79.69	\$96.28
5	x2 1/2	2.30	\$80.58	\$98.96
	x3	2.60	\$98.36	\$117.32
	x4	4.50	\$565.86	\$615.63
	x1*	6.00	\$153.76	\$189.02
6	x 1 1/2*	6.10	\$153.76	\$189.02
	x2	6.00	\$153.76	\$189.02
	x3	6.00	\$153.76	\$189.02
	x4	5.90	\$153.76	\$189.02
	x5	5.80	\$153.76	\$203.64
8	x3*	9.30	\$251.52	\$334.54
	x4	10.40	\$251.52	\$334.54
	x5*	11.60	\$251.52	\$334.54
	x6	11.90	\$320.67	\$427.92

\*Fabricated Steel  
Reducer sizes not shown, will be priced on application.

\*Gruvlok fittings are full flow fittings made of ductile iron except those marked (\*) which are fabricated steel.

**Mechanical Tee Products Clamp-T®,  
Fig. 7046 Grooved Outlet**

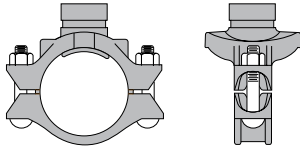

NOMINAL PIPE SIZE RUN (INCHES)	OUTLET (INCHES)	APRX. WEIGHT EACH (LBS)	COMPLETE WITH CLAMP-T GROOVED BRANCH PRICE EACH		BOLT & NUT SIZE (INCHES)
			PAINTED	GALVANIZED	
2 1/2**	x 1 1/4	3.40	\$60.15	\$73.76	1/2 U-Bolt
	x 1 1/2	3.40	\$60.15	\$73.76	1/2 U-Bolt
3	x 1 1/4	3.40	\$62.80	\$78.81	1/2 x 2 3/4
	x 1 1/2	4.40	\$62.80	\$78.81	1/2 x 2 3/4
4	x 2	4.60	\$72.28	\$90.35	1/2 x 2 3/4
	x 1 1/4	4.20	\$73.47	\$86.22	1/2 x 2 3/4
	x 1 1/2	4.30	\$76.14	\$96.28	1/2 x 2 3/4
	x 2	4.60	\$76.14	\$97.17	1/2 x 2 3/4
5	x 2 1/2	5.00	\$79.40	\$103.99	1/2 x 2 3/4
	x 3	5.60	\$85.03	\$109.62	1/2 x 3 1/2
	x 1 1/4	5.00	\$88.77	\$123.61	5/8 x 3 1/4
	x 1 1/2	5.60	\$93.32	\$118.80	5/8 x 3 1/4
6	x 2	5.50	\$93.32	\$118.80	5/8 x 3 1/4
	x 2 1/2	5.80	\$98.65	\$125.91	5/8 x 3 1/4
	x 3	7.10	\$105.17	\$135.98	5/8 x 3 1/4
	x 1 1/4	7.20	POA	POA	5/8 x 4 1/4
	x 1 1/2	7.20	\$95.40	\$123.24	5/8 x 4 1/4
8	x 2	7.80	\$95.40	\$123.24	5/8 x 4 1/4
	x 2 1/2	7.60	\$103.39	\$133.62	5/8 x 4 1/4
	x 3	8.00	\$109.91	\$141.91	5/8 x 4 1/4
8	x 4	10.40	\$121.77	\$158.79	5/8 x 4 1/4
	x 2	10.40	\$168.57	\$213.31	3/4 x 4 1/4
	x 2 1/2	10.60	\$168.57	\$213.31	3/4 x 4 1/2
	x 3	11.50	\$178.05	\$226.04	3/4 x 4 1/2
	x 4	16.20	\$183.38	\$237.30	3/4 x 4 1/2

Clamp T's are available in Grade E Gasket or Grade T Buna on request.  
All bolts and nuts are of track head design and are zinc plated conforming to physical properties of ASTM B-633.  
\*\*Clamp-T supplied with U-bolt lower housing.

**Mechanical Tee Products Clamp-T®,  
Fig. 7045 with Female Threaded Outlet**

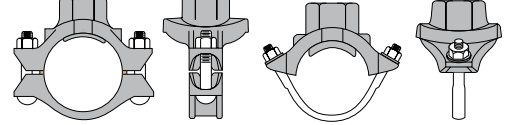

Fig. 7045 (U-Bolt)

NOMINAL PIPE SIZE RUN (INCHES)	OUTLET (INCHES)	APRX. WEIGHT EACH (LBS)	COMPLETE WITH CLAMP-T WITH "E" GRADE GASKET FEMALE THREADED OUTLET PRICE EACH		*BOLT & NUT SIZE
			PAINTED	GALVANIZED	
2	x 1/2**	3.00	\$42.66	\$53.62	1/2 U-Bolt
	x 3/4**	2.90	\$42.66	\$53.62	1/2 U-Bolt
	x 1**	2.90	\$42.66	\$53.62	1/2 U-Bolt
	x 1 1/4**	4.00	\$60.15	\$61.33	1/2 U-Bolt
	x 1 1/2**	3.90	\$60.15	\$61.33	1/2 U-Bolt
2 1/2	x 1 1/2**	3.00	\$42.66	\$53.62	1/2 U-Bolt
	x 3/4**	2.90	\$42.66	\$53.62	1/2 U-Bolt
	x 1**	2.90	\$42.66	\$53.62	1/2 U-Bolt
	x 1 1/4**	3.40	\$60.15	\$73.76	1/2 U-Bolt
3	x 1 1/2**	3.40	\$60.15	\$73.76	1/2 U-Bolt
	x 1/2**	2.80	\$49.18	\$59.85	1/2 U-Bolt
	x 3/4**	2.70	\$49.18	\$59.85	1/2 U-Bolt
	x 1**	2.70	\$49.18	\$59.85	1/2 U-Bolt
	x 1 1/4	3.40	\$62.80	\$78.81	1/2 x 2 3/4
4	x 1 1/2	4.40	\$62.80	\$78.81	1/2 x 2 3/4
	x 2	4.60	\$72.28	\$90.35	1/2 x 2 3/4
	x 1/2**	2.90	\$62.22	\$74.37	1/2 U-Bolt
	x 3/4**	2.80	\$62.22	\$74.37	1/2 U-Bolt
	x 1**	2.70	\$62.22	\$74.37	1/2 U-Bolt
5	x 1 1/4	4.50	\$73.47	\$86.22	1/2 x 2 3/4
	x 1 1/2	4.60	\$76.14	\$96.28	1/2 x 2 3/4
	x 2	5.20	\$76.14	\$96.28	1/2 x 2 3/4
	x 2 1/2	5.20	\$79.40	\$103.99	1/2 x 2 3/4
	x 3	6.50	\$85.03	\$109.62	1/2 x 3 1/2
6	x 1 1/4	5.40	\$75.60	\$123.61	5/8 x 3 1/4
	x 1 1/2	5.50	\$93.32	\$118.80	5/8 x 3 1/4
	x 2	5.70	\$93.32	\$118.80	5/8 x 3 1/4
	x 2 1/2	7.00	\$98.65	\$125.91	5/8 x 3 1/4
	x 3	8.70	\$105.17	\$135.98	5/8 x 3 1/4
8	x 1 1/4	7.80	\$77.45	\$128.35	5/8 x 4 1/4
	x 1 1/2	7.80	\$95.40	\$123.24	5/8 x 4 1/4
	x 2	7.80	\$95.40	\$123.24	5/8 x 4 1/4
	x 2 1/2	8.40	\$103.39	\$133.62	5/8 x 4 1/4
8	x 3	9.60	\$109.91	\$141.91	5/8 x 4 1/4
	x 4	10.50	\$121.77	\$158.79	5/8 x 4 1/4
	x 2***	10.90	\$168.57	\$213.31	3/4 x 4 1/4
	x 2 1/2	11.10	\$168.57	\$213.31	3/4 x 4 1/2
	x 3	13.00	\$178.05	\$226.04	3/4 x 4 1/2
	x 4	16.20	\$183.38	\$237.30	3/4 x 4 1/2

Clamp T's are available with grooved or female threaded outlet with Grade E or Grade T gasket. Weights are approximate and subject to change.  
\*All bolts and nuts are of track head design and are zinc plated conforming to physical properties of ASTM B-633.  
\*\*Clamp-T supplied with U-bolt lower housing.  
\*\*\*Note: 8 x 2 is actually 8 x 2 1/2 bushed down.



**Mechanical Tee Products**

**Clamp-T® Cross, Fig. 7047, Fig. 7048 and Fig. 7049**

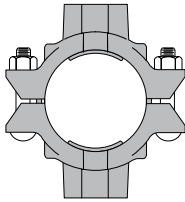

Fig. 7047 – Thread x Thread

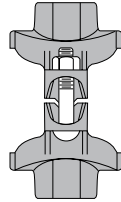

Fig. 7048 – Groove x Groove

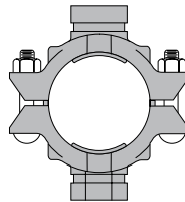

Fig. 7049 – Groove x Thread

NOMINAL PIPE SIZE RUN (INCHES)	OUTLET (INCHES)	COMPLETE WITH CLAMP-T CROSS WITH "E" GASKET PRICE EACH	
		PAINTED	GALVANIZED
2½	1 x 1*	\$67.54	\$87.39
	1 x 1¼*	\$93.91	\$121.47
	1 x 1½*	\$93.91	\$121.47
	1¼ x 1¼*	\$93.91	\$121.47
	1½ x 1¼*	\$93.91	\$121.47
	1½ x 1½*	\$93.91	\$121.47
3	1 x 1*	\$76.14	\$98.65
	1 x 1¼	\$93.91	\$117.91
	1 x 1½	\$93.91	\$117.91
	1 x 2	\$109.56	\$145.81
	1¼ x 1¼	\$93.91	\$117.91
	1½ x 1¼	\$93.91	\$117.91
	1½ x 1½	\$93.91	\$117.91
	2 x 1¼	\$109.56	\$145.81
	2 x 1½	\$109.56	\$145.81
4	1 x 1*	\$94.22	\$122.06
	1 x 1¼	\$110.39	\$152.04
	1 x 1½	\$115.31	\$158.61
	1 x 2	\$123.30	\$170.82
	1¼ x 1¼	\$114.06	\$143.68
	1½ x 1¼	\$114.06	\$143.68
	1½ x 1½	\$114.06	\$143.68
	2 x 1¼	\$114.06	\$144.87
	2 x 1½	\$122.06	\$144.87
	2 x 2	\$122.06	\$144.87
	2½ x 2½	\$122.06	\$155.53
	3 x 3	\$127.69	\$164.72

NOMINAL PIPE SIZE RUN (INCHES)	OUTLET (INCHES)	COMPLETE WITH CLAMP-T CROSS WITH "E" GASKET PRICE EACH	
		PAINTED	GALVANIZED
5	1½ x 1½	\$139.54	\$178.05
	2 x 1½	\$139.54	\$178.05
	2 x 2	\$139.54	\$178.05
	2½ x 1½	\$149.14	\$203.47
	2½ x 2	\$149.14	\$203.47
	2½ x 2½	\$147.54	\$189.02
	3 x 1½	\$159.51	\$219.18
	3 x 2	\$159.51	\$219.18
	3 x 2½	\$159.51	\$219.18
6	1½ x 1½	\$144.63	\$199.09
	2 x 1½	\$143.10	\$184.57
	2 x 2	\$144.63	\$199.09
	2½ x 2½	\$154.95	\$199.68
	3 x 2½	\$164.43	\$212.12
	3 x 3	\$164.43	\$212.12
	4 x 2½	\$184.10	\$256.50
	4 x 3	\$184.10	\$256.50
	4 x 4	\$181.90	\$237.60
8	2½ x 2½	\$252.41	\$319.37
	3 x 2½	\$269.77	\$365.70
	3 x 3	\$266.34	\$338.91
	4 x 2½	\$277.47	\$384.19
	4 x 3	\$277.47	\$384.19
	4 x 4	\$274.92	\$355.81

\*Available with female threaded outlet only.

\*\*Only available in Fig. 7047 or Fig. 7049

Always Verify Figure Number for Appropriate Combination of Outlets.

**Always specify gasket grade when ordering. Some additional configurations available. Contact your Anvil rep for details.**

**Steel Cross Fig. 7068**

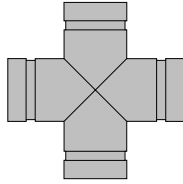

NOMINAL PIPE SIZE (INCHES)	APRX. WEIGHT EACH (LBS)	PRICE EACH	
		PAINTED	GALVANIZED
1	1.30	\$165.91	\$191.39
1¼	2.10	\$200.28	\$233.45
1½	2.50	\$215.68	\$250.33
2	2.90	\$122.35	\$146.05
2½	5.20	\$122.35	\$146.05
3	7.50	\$219.23	\$268.70
3½	9.80	\$441.43	\$527.04
4	12.20	\$364.40	\$448.53
5	17.60	\$743.61	\$897.07
6	28.30	\$956.03	\$1,159.86
8	48.00	\$1,259.10	\$1,558.02

**End of the Line Fitting (EOL) Fig. 7091**



NOMINAL RUN SIZE (INCHES)	BRANCH (INCHES)	APRX. WEIGHT EACH (LBS)	COMPLETE WITH CLAMP-T CROSS WITH "E" GASKET PRICE EACH	
			PAINTED	GALVANIZED
1¼	x ½	0.70	\$40.29	\$50.66
	x ¾	0.70	\$40.29	\$50.66
	x 1	0.70	\$40.29	\$50.66
1½	x ½	0.80	\$40.29	\$50.66
	x ¾	0.80	\$40.29	\$50.66
	x 1	0.80	\$40.29	\$50.66
2	x ½	1.00	\$43.85	\$57.48
	x ¾	1.00	\$43.85	\$57.48
	x 1	1.00	\$43.85	\$57.48
2½	x ½	1.40	\$52.14	\$63.10
	x ¾	1.40	\$52.14	\$63.10
	x 1	1.40	\$52.14	\$63.10

**UL/FM Butterfly Valves Fig. AE7722-3A (300 PSI)**

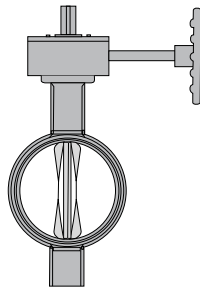

NOMINAL PIPE SIZE (INCHES)	APRX. WEIGHT EACH (LBS)	PRICE EACH
2	10.00	\$554.42
2½	10.50	\$554.42
3	11.50	\$599.98
4	13.50	\$628.54
5	19.00	\$942.81
6	33.50	\$894.11
8	59.00	\$1,371.08
10	78.04	\$2,108.88

Valve pre-wired less conduit fitting.  
EPDM Seats Recommended for Fire Services.

**UL/FM Series 78FP Fire Check Valve (300 PSI)**

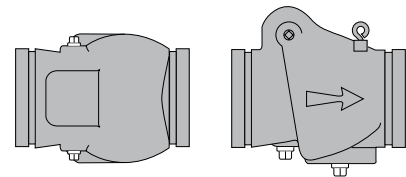

NOMINAL PIPE SIZE (INCHES)	APRX. WEIGHT EACH (LBS)	PRICE EACH
2	7.50	\$413.81
2½	10.50	\$413.81
3	11.50	\$489.07
4	13.50	\$516.62
5	19.00	\$860.22
6	33.50	\$1,020.14
8	59.00	\$1,394.13
10	130.00	\$4,034.56
12	183.00	\$4,781.59

The series 78FP Gruvlok Check Valve come standard with cast ductile iron body, stainless steel seat ring, hinge pin and closure spring. Clapper seat facing is of Grade "E". NPT plugs in the body accommodate valve drain-down. Trim options available upon request.

## Sock-It<sup>®</sup> Fittings

### Sock-It<sup>®</sup> 90° Straight Elbow Fig. 7100



For listing/approval details contact your AnvilStar Representative.

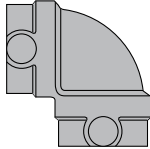

NOMINAL RUN SIZE (INCHES)	APRX. WEIGHT EACH (LBS)	CARTON QUANTITY	PRICE PER UNIT "E" GASKET BLACK
1	1.90	30	\$28.03
1¼	2.30	30	\$32.77
1½	2.70	20	\$36.03
2	4.00	10	\$42.48

Provided in carton quantity only.  
Grade E gaskets unless otherwise specified.

### Sock-It<sup>®</sup> Reducing Elbow Fig. 7101



For listing/approval details contact your AnvilStar Representative.

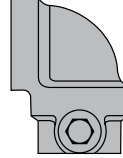

NOMINAL RUN SIZE (INCHES)	OUTLET (INCHES)	APRX. WEIGHT EACH (LBS)	CARTON QUANTITY	PRICE PER UNIT "E" GASKET BLACK
1	x ½	1.70	45	\$33.54
	x ¾	1.60	45	\$33.54
	x 1	1.50	45	\$33.54
1¼	x ½	2.20	30	\$34.66
	x ¾	2.10	30	\$34.66
	x 1	2.00	30	\$34.66
1½	x ½	2.50	30	\$35.73
	x ¾	2.40	30	\$35.73
	x 1	2.30	30	\$35.73

Provided in carton quantity only.  
Grade E gaskets unless otherwise specified.

### Sock-It<sup>®</sup> Straight Tee Fig. 7103



For listing/approval details contact your AnvilStar Representative.

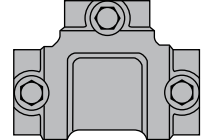

NOMINAL RUN SIZE (INCHES)	APRX. WEIGHT EACH (LBS)	CARTON QUANTITY	PRICE PER UNIT "E" GASKET BLACK
1	2.30	20	\$43.14
1¼	2.90	15	\$45.63
1½	3.40	15	\$53.27
2	5.60	10	\$55.83

Provided in carton quantity only.  
Grade E gaskets unless otherwise specified.

### Sock-It<sup>®</sup> Reducing Outlet Tee Fig. 7105



For listing/approval details contact your AnvilStar Representative.

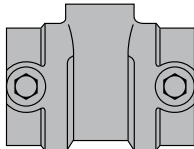

NOMINAL RUN SIZE (INCHES)	OUTLET (INCHES)	APRX. WEIGHT EACH (LBS)	CARTON QUANTITY	PRICE PER UNIT "E" GASKET BLACK
1 x 1	x ½	2.00	30	\$26.43
	x ¾	1.90	30	\$26.43
	x 1	1.90	30	\$26.43
1¼ x 1¼	x ½	2.20	30	\$26.43
	x ¾	2.20	30	\$26.43
	x 1	2.00	30	\$26.43
1½ x 1½	x ½	2.70	25	\$27.79
	x ¾	2.60	25	\$27.79
	x 1	2.50	25	\$27.79
2 x 2	x ½	3.50	15	\$34.07
	x ¾	3.40	15	\$34.07
	x 1	3.30	15	\$34.07
2½ x 2½	x ¾	5.20	5	\$45.63
	x 1	5.00	5	\$45.63

Provided in carton quantity only.  
Grade E gaskets unless otherwise specified.

### Sock-It<sup>®</sup> Reducing Run Outlet Tee Fig. 7106



For listing/approval details contact your AnvilStar Representative.

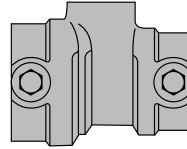

NOMINAL RUN SIZE (INCHES)	OUTLET (INCHES)	APRX. WEIGHT EACH (LBS)	CARTON QUANTITY	PRICE PER UNIT "E" GASKET BLACK
1¼	x 1 x ½	2.10	30	\$28.09
	x 1 x ¾	2.10	30	\$28.09
	x 1 x 1	2.00	30	\$28.09
1½	x 1¼ x ½	2.50	25	\$29.81
	x 1¼ x ¾	2.40	25	\$29.81
	x 1¼ x 1	2.20	25	\$29.81
2	x 1½ x ½	3.10	15	\$36.27
	x 1½ x ¾	3.10	15	\$36.27
	x 1½ x 1	3.00	15	\$36.27

Provided in carton quantity only.  
Grade E gaskets unless otherwise specified.

### Sock-It<sup>®</sup> Coupling Fig. 7107



For listing/approval details contact your AnvilStar Representative.

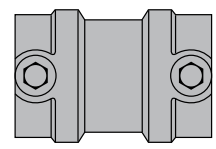

NOMINAL RUN SIZE (INCHES)	APRX. WEIGHT EACH (LBS)	CARTON QUANTITY	PRICE PER UNIT "E" GASKET BLACK
1	1.70	50	\$25.25
1¼	1.90	30	\$25.25
1½	2.10	25	\$31.64
2	2.90	20	\$31.64

Provided in carton quantity only.  
Grade E gaskets unless otherwise specified.

## Spare Parts

**For use with Fig. 7000  
and 7400 Coupling  
(Dri-Seal™ Grade E Type A Gasket)**

NOMINAL PIPE SIZE (INCHES)	SPARE PARTS TYPE A GASKET ONLY
1¼	\$16.88
1½	\$17.66
2	\$18.49
2½	\$22.46
3	\$25.60
4	\$31.64
5	\$42.13
6	\$46.87
8	\$67.25

Dri-Seal Gaskets are non-cancellable and non-returnable.

**Reducing Coupling Fig. 7010  
(Grade "E" Gasket) Loose**

NOMINAL PIPE SIZE (INCHES)	SPARE PARTS "E" GASKET ONLY PRICE EACH
2 x 1½	\$16.01
2½ x 2	\$21.04
3 x 2	\$24.88
3 x 2½	\$24.88
4 x 2	\$28.44
4 x 2½	\$28.74
4 x 3	\$30.23
5 x 4	\$35.26
6 x 4	\$40.29
6 x 5	\$43.85
8 x 6	\$48.59

Gaskets are non-cancellable and non-returnable.

**Sock-It® Fittings  
Spare Parts**

NOMINAL RUN SIZE (INCHES)	PRICE EACH	
	GASKET	BOLT
1	\$6.76	\$2.97
1¼	\$7.95	\$2.97
1½	\$9.54	\$2.97
2	\$10.08	\$2.97
2½	\$12.21	\$2.97

Gaskets are non-cancellable and non-returnable.

## Standard Gaskets for Fire Protection

GRADE	TEMPERATURE RANGE	COMPOUND	COLOR CODE	*GENERAL SERVICE APPLICATION
E	-40°F to +230°F (-40°C to +110°C)	EPDM	Green	Water, dilute acids, alkalis, salts and many chemical services not involving hydrocarbons, oils or gases. Excellent oxidation resistance. NOT FOR USE WITH HYDROCARBONS
E (type A)	-40°F to +150°F (-40°C to +65°C)		Violet	Wet and Dry (oil free air) pipe fire protection sprinkler systems. For dry pipe systems, Gruvlok Xtreme™ Lubricant is required.

\*Contact Anvil for specific service recommendations. **SPECIFY GASKET GRADE WHEN ORDERING.**  
Use Gruvlok lubricant on gaskets. Check gasket color code to be certain it is recommended for the service intended.  
Additional gasket compounds and configurations are available - contact Anvil.

LUBRICANTS	
STANDARD LUBRICANT	PRICE
4 ½ oz. Tube	\$23.74/tube
Carton (w/12 Packs, 144 Tubes)	\$2,818.54/carton
1 Quart Can	\$121.85/can
5 Gallon Pail	\$1,029.72/pail
QUICK DRY LUBRICANT	
1 Pint Can	\$92.87
1 Quart Can	\$130.64
1 Gallon Pail	\$221.50
XTREME LUBRICANT (SILICONE)	
10 oz. Tube (1 each)	\$60.37
2.2 lb. Tub (Gruvlok Lubricant)	\$212.53

STANDARD LUBRICANT USAGE GUIDE		
SIZE OF GASKET	NUMBER OF GASKETS	
	PER TUBE	PER QUART
2"	55	400
3"	45	300
4"	25	200
6"	20	130
8"	15	100
10"	10	85
12"	9	60
14"	7	50
16"	6	40
18"	5	35
20"	4	30
24"	3	20

XTREME LUBRICANT USAGE GUIDE	
SIZE OF GASKET	NUMBER OF GASKETS PER QUART
	2"
3"	900
4"	600
6"	390
8"	300
10"	255
12"	180
14"	150
16"	120
18"	105
20"	90
24"	60

## Cross Reference

DESCRIPTION	GRUVLOK®	ANVIL/SPF™	VICTAULIC®	GRINNEL (CENTRAL®)
Rigid Coupling	7400	C-4	005	572
Light Weight Coupling	7000	C-3, C-1	75	575
Reducer Coupling	7010	RC-1	750	716
Standard 90° Elbow	7050S/7050	E-1	10	510
Standard 45° Elbow	7051FP/7051	E-2	11	501
Standard 22½° Elbow	7052	E-3 (SW)	12	312
Standard 11¼° Elbow	7053	E-4 (SW)	13	313
Standard Reducer Tee	7061	T-2 (SW)	25	321 (SW)
Straight Tee with Thread Outlet	7063	N/A	29M	320 (SW)
Reducing Tee with Thread Outlet	7064	T-3 (SW)	29T	323 (SW)
Concentric Reducer	7072	R-1 (SW)	50	350 (SW)
Concentric Reducer with Thread Outlet	7076	R-3 (SW)	52	372 (SW)
Eccentric Reducer	7073	R-2 (SW)	51 (SW)	351 (SW)
Drain Elbow	7050DR	E-9	10DR	N/A
Short Pattern 90° Elbow	7450	SE-1	001	N/A
Short Pattern Straight Tee	7460	ST-1	002	N/A
Bullhead Tee	7062	N/A	21	N/A
Standpipe Tee	7065	N/A	27	N/A
Fire Grooved Cap	7074	SK-1/K-1	006	260
Cross	7068	X-1	N/A	N/A
Thread Mechanical Tee	7045	MT-1	920	730
End of the Line Fitting	7091	SE-5	N/A	N/A
Groove Mechanical Tee	7046	MT-2	920	730
Sprinkler Outlet Tee (U-Bolt)	7044	MT-3	921, 925	40-5
Groove Flange Adapter	7012FP	SF-1/F-1	744	71
Flange/Groove Nipple	7083	F-2 (SW)	41	341/142
Plain-End Coupling	7005	N/A	90	N/A
Outlet Coupling	7042	N/A	72	N/A

TM - Thread Male

TF - Thread Female

SW - Segmented Welded Fitting – not available in cast ductile fitting.

- NOTES -

- NOTES -



**Corporate Offices**

110 Corporate Drive, Suite 10  
P.O. Box 3180  
Portsmouth, NH 03802-3180  
Tel: 603-422-8000  
Fax: 603-422-8033  
E-mail: webmaster@anvilintl.com

**Anvil International  
Worldwide Customer  
Service Center**

Tel: 708-534-1414  
Fax: 708-534-5441

**U.S. REGIONAL SERVICE CENTERS**

**Eastern Region**

**SERVICING:** Connecticut, Delaware, Florida,  
Georgia, Maine, Maryland, Massachusetts, New Hampshire,  
New Jersey, New York, North and South Carolina,  
East Pennsylvania, Rhode Island, Vermont, Virginia  
800 Malleable Road  
Columbia, PA 17512  
Tel: 800-451-2935  
Fax: 800-272-2983  
Toll-Free: 1-800-301-2701

**Northern Region**

**SERVICING:** Illinois, Indiana, Iowa, Kentucky, Michigan,  
Minnesota, Nebraska, North and South Dakota, Ohio,  
West Pennsylvania, West Virginia, Wisconsin  
750 Central Avenue  
University Park, IL 60466  
Tel: 708-534-1414  
Fax: 708-534-5441  
Toll-Free: 1-800-301-2701

**Southern Region**

**SERVICING:** Alabama, Arkansas, Kansas, Louisiana,  
Mississippi, Missouri, Oklahoma, Tennessee, Texas  
1313 Avenue R  
Grand Prairie, TX 75050  
Tel: 972-343-9206  
Fax: 972-641-8946  
Toll-Free: 1-800-451-4414

**Western Region**

**SERVICING:** Alaska, Arizona, California, Colorado,  
Hawaii, Idaho, Montana, Nevada, New Mexico, Oregon,  
Utah, Washington, Wyoming  
1385 Greg Street  
Sparks, NV 89431  
Tel: 775-331-7029  
Fax: 775-331-5075  
Toll-Free: 1-800-572-0051

**CANADA SERVICE CENTERS**

**Corporate**

390 Second Avenue  
Simcoe, Ontario N3Y 4K9  
Tel: (519) 426-4551

**Western**

5506-48 St. NW  
Edmonton, Alberta, T6B 2Z1  
Tel: (780) 413-8274

**Central**

390 Second Avenue  
Simcoe, Ontario N3Y 4K9  
Tel: (519) 426-4551

**Eastern**

2615-25 Brabant-Marineau. (Saint-Laurent)  
Montreal, Quebec, H4S 1R8  
Tel: (514) 745-3835

**INTERNATIONAL SALES**

**Europe & Middle East Region**

Rick van Meesen, Director of Sales  
The Netherlands  
Tel: +31-53-5725570  
Fax: +31-53-5725579

U.S. Customer Service  
Tel: +1-708-534-1414  
Fax: +1-708-534-5441

**Latin America**

Abraham Quijada, Sales Manager  
Tel: +1-281-590-4600  
U.S. Customer Service  
Tel: +1-708-534-1414  
Fax: +1-708-534-5441

**Puerto Rico**

R.R. Barril, Inc.  
Tel: +1-787-982-1550  
Fax: +1-787-982-1570  
U.S. Customer Service  
Tel: +1-708-534-1414  
Fax: +1-708-534-5441

**Mexico**

Jose Antonio Bueno  
Mexico  
Tel: +52-777-169-4546  
U.S. Customer Service  
Tel: +1-708-534-1414  
Fax: +1-708-534-5441

#613A / Printed in USA / 7.07 / ©2008

B U I L D I N G C O N N E C T I O N S T H A T L A S T



www.anvilintl.com